

Price List
Liste de Prix
Tarifa de Precios

2020



www.lifial.pt



Lifial is certified according to the ISO 9001:2015



Lifial is certified according to the ISO 14001:2015



Lifial

Was founded in 1988 and has more than 30 years of experience in the Market, producing metal clamps for fastening, agriculture and industry. It is located in Águeda and occupies a total area of 10.500m².

Mission

Commercialize our products by providing excellent service in respect of ethical principles with the intention to create added value for our customers, employees and suppliers.

Main Objectives;

Producing and commercialize our products with high quality.
Achieve customer loyalty through service.



Índice



Ab. Sem Fim

Pág. 1 e 2



Expositor Ab. Sem Fim

Pág. 1



Mala Ab. Sem Fim

Pág. 1



Chave Flexível

Pág. 2



Ab. Norma

Pág. 3 e 4



Ab. Mini-Flex

Pág. 5



Ab. Minus

Pág. 5



Ab. Perfurada

Pág. 6



Ab. Aba

Pág. 7



Ab. Cabeça Basculante

Pág. 8



Ab. Plana

Pág. 9



Ab. Tubo Espiral

Pág. 9



Fita Perfurada e Cabeças

Pág. 10



Fita NB-G e Cabeças

Pág. 11



Fita não Perf. e Cabeças

Pág. 11



Fita NB-D e Cabeças

Pág. 12



Máquina p/ Fita NB-D

Pág. 12



Ganchos de Soldar

Pág. 12

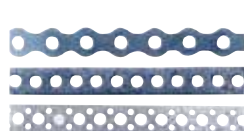

Fita Ondulada, Recta e Multi Furo

Pág. 13



Ab. Tipo "L"

Pág. 14



Ab. Arame

Pág. 15



Ab. Escala

Pág. 16



Ab. Foles Cardan

Pág. 16



Ab. Fivela Inox

Pág. 17



Ab. 2 Orelhas

Pág. 17



Ab. 1 Orelha

Pág. 18



Alicates

Pág. 18



Ab. Gás

Pág. 19



Ab. Hercules

Pág. 20



Ab. Escape

Pág. 20



Ab. Super

Pág. 21 à 31



Ab. Perfil

Pág. 32



Ab. Tipo Italiano

Pág. 32



Ab. Tipo "E" e "D"

Pág. 33



Ab. Liftube

Pág. 34



Ab. com Porca

Pág. 35



Ab. Marca Interior

Pág. 35



Parafuso p/ Ab.

Pág. 35 e 38



Ab. Reforçada

Pág. 35, 38 e 40



Ab. Reforçada c/ Borracha

Pág. 37, 39 e 41



Base Rect. c/ Porca

Pág. 41



Ab. Pêra

Pág. 42



Porca Rebitar Estriada

Pág. 42



Capas

Pág. 43



Ab. Alimentária

Pág. 43



Grapas

Pág. 44



Parafusos e Porcas p/ Calha

Pág. 45



Suportes Perfurados

Pág. 46



Suportes

Pág. 46



Abarcones

Pág. 47 e 48



Ab. Fivela Poliamida

Pág. 49



Bucha e Base p/ Fixar Ab.

Pág. 49



Hastes Roscadas

Pág. 50



Tightening Clamps Tubes
Abraçadeiras Aperto Tubos

We Control Galvanization Process

Controlamos o Processo de Galvanização

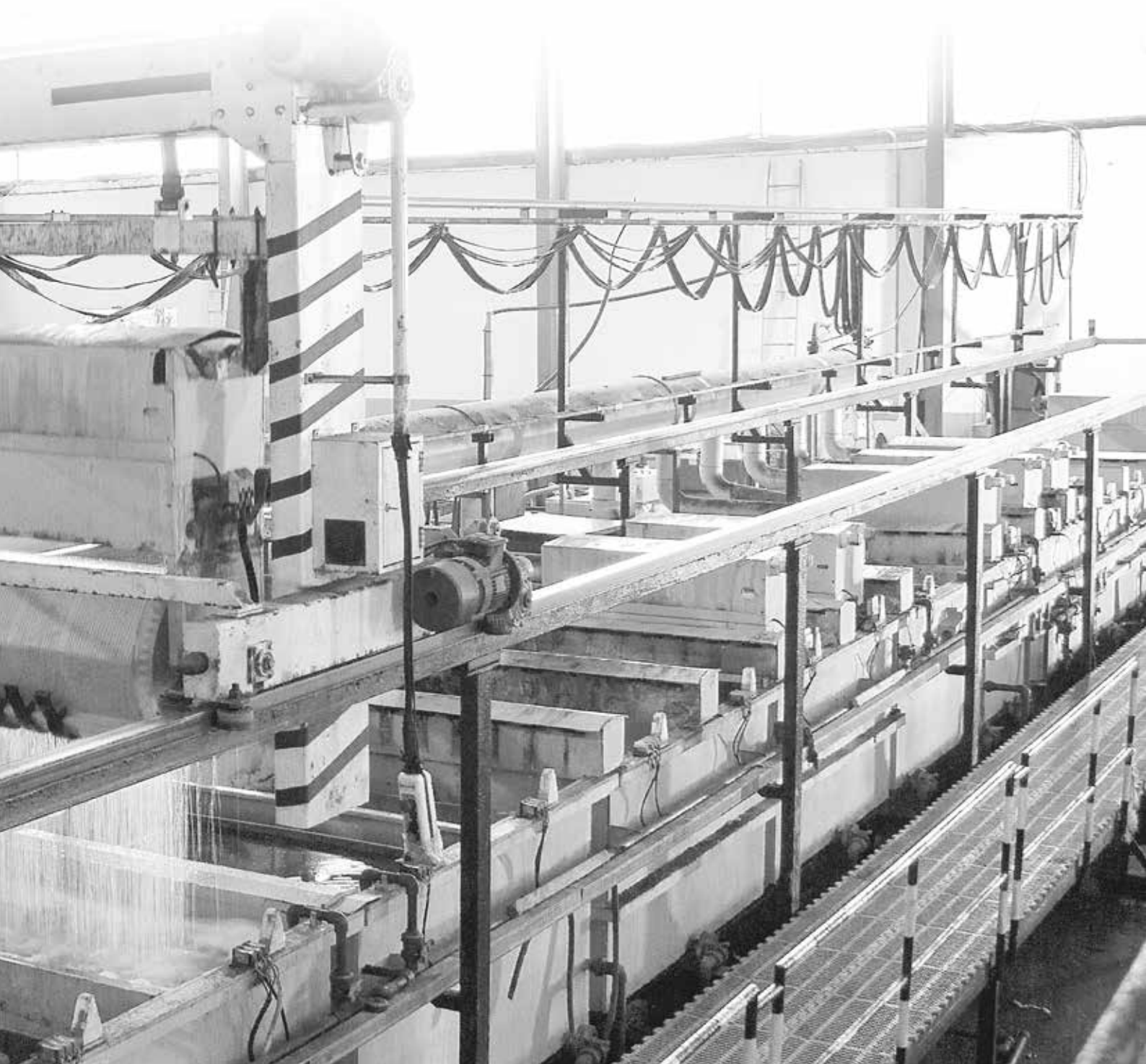

ABRAÇADEIRA SEM FIM DIN 3017**SEM FIM CLAMP DIN 3017****COLLIER SANS FIN DIN 3017****ABRAZADERA SIN FIN DIN 3017****Fabricado em Banda 9mm**

Und Cx	Medida Size Measure	Aperto Range Serrage	W1		W2		W4		W5	
			Code / Price / Prix Código € / 100PCS		Code / Price / Prix Código € / 100PCS		Code / Price / Prix Código € / 100PCS		Code / Price / Prix Código € / 100PCS	
100		8-12	1ASFE012	10,69	1ASFE2012	14,04	1ASFEI012	32,41		
100	3/16	10-16	1ASFE0316	10,69	1ASFE20316	14,04	1ASFEI0316	32,41	1ASFEI5316	35,65
100	3/8	12-22	1ASFE038	12,13	1ASFE2038	15,12	1ASFEI038	33,36	1ASFEI5038	36,69
100	1/2	16-27	1ASFE050	12,41	1ASFE2050	15,51	1ASFEI050	34,96	1ASFEI5050	38,45
100	3/4	20-32	1ASFE075	13,38	1ASFE2075	17,31	1ASFEI075	40,42	1ASFEI5075	44,47
100	7/8	23-35	1ASFE078	13,74	1ASFE2078	17,64	1ASFEI078	41,90		
100	1"	25-40	1ASFE100	14,15	1ASFE2100	18,00	1ASFEI100	43,00	1ASFEI5100	47,30
50	1 1/4	30-45	1ASFE125	14,90	1ASFE2125	19,11	1ASFEI125	44,02	1ASFEI5125	49,35
50	1 1/2	32-50	1ASFE150	15,29	1ASFE2150	20,16	1ASFEI150	45,24	1ASFEI5150	51,17
50	1 3/4	40-60	1ASFE175	17,62	1ASFE2175	21,61	1ASFEI175	50,99	1ASFEI5175	56,09
50	2"	50-70	1ASFE200	19,20	1ASFE2200	23,41	1ASFEI200	51,99	1ASFEI5200	57,18
50	2 1/2	60-80	1ASFE250	20,41	1ASFE2250	25,21	1ASFEI250	54,86	1ASFEI5250	60,66
50	3"	70-90	1ASFE300	20,83	1ASFE2300	26,29	1ASFEI300	57,43	1ASFEI5300	63,31
50		80-100	1ASFE350	21,22	1ASFE2350	27,37	1ASFEI350	60,95	1ASFEI5350	68,19
50	4"	90-110	1ASFE400	21,61	1ASFE2400	28,09	1ASFEI400	63,22		
50		100-120	1ASFE450	22,44	1ASFE2450	29,89	1ASFEI450	68,34		
50	5"	110-130	1ASFE500	24,01	1ASFE2500	30,61	1ASFEI500	68,96		
50		120-140	1ASFE550	24,85	1ASFE2550	33,49	1ASFEI550	75,08		

Recomendação Resistência
Recommendation Resistance
Recommandation Résistance

W1	W2	W4	W5
3Nm	3,5Nm	4Nm	4Nm

W1 Totalmente Zincado/ Fully Zinc Plated Steel / Entièrement en Acier Zingué / Acero Cincado

W2 Fita e Cabeça Inox AISI 430 e PF Zincado/Band & Head in AISI 430 & Zinc Plated Screw/Bande et Tête en Acier inox 430 et vis acier Zingué

W4 Totalmente em Inox AISI 304 / Fully Stainless AISI 304 / Entièrement en Acier Inox AISI 304 / Acero Inoxidable AISI 304

W5 Totalmente em Inox AISI 316 / Fully Stainless AISI 316 / Entièrement en Acier Inox AISI 316 / Acero Inoxidable AISI 316

EXPOSITOR ABRAÇADEIRA SEM FIM**DISPLAY SEM FIM CAMP****PRÉSENTOIR COLLIERS SANS FIN****SIMPLES**

Simple

W1	
Código	
1EASFS	11,58

MALA ABRAÇADEIRA SEM FIM**HANDBAG SEM FIM CLAMP****VALISE COLLIER SANS FIN**

Aperto (mm)	Peças	W1	
		Código	€/1PCS
8 - 12	20	1MASF	18,74
10 - 16	30		
12 - 22	20		
16 - 27	15		
25 - 40	10		
Chave	1		

ABRAÇADEIRA SEM FIM DIN 3017**SEM FIM CLAMP DIN 3017****COLLIER SANS FIN DIN 3017****ABRAZADERA SIN FIN DIN 3017****Fabricado em Banda 12mm**

Und Cx	Medida Size Measure	Aperto Range Serrage	W1		W2		W4		W5	
			Code / Price / Prix Código € / 100PCS		Code / Price / Prix Código € / 100PCS		Code / Price / Prix Código € / 100PCS		Code / Price / Prix Código € / 100PCS	
100	1/2	16-27	1ASF050	14,38	1ASF2050	19,42	1ASFI050	46,07		
100	3/4	20-32	1ASF075	15,94	1ASF2075	21,84	1ASFI075	48,95	1ASFI5075	53,85
100	7/8	23-35	1ASF078	16,40	1ASF2078	22,21	1ASFI078	50,10		
100	1"	25-40	1ASF100	16,73	1ASF2100	22,53	1ASFI100	54,41	1ASFI5100	59,85
100	1 1/4	30-45	1ASF125	17,72	1ASF2125	23,94	1ASFI125	57,05	1ASFI5125	62,75
50	1 1/2	32-50	1ASF150	18,41	1ASF2150	25,62	1ASFI150	58,19	1ASFI5150	64,01
50	1 3/4	40-60	1ASF175	21,23	1ASF2175	27,03	1ASFI175	63,68	1ASFI5175	70,05
50	2"	50-70	1ASF200	22,88	1ASF2200	29,48	1ASFI200	66,77	1ASFI5200	73,45
25	2 1/2	60-80	1ASF250	24,94	1ASF2250	31,56	1ASFI250	75,00	1ASFI5250	82,50
25	3"	70-90	1ASF300	25,35	1ASF2300	32,95	1ASFI300	79,77	1ASFI5300	87,74
25		80-100	1ASF350	29,24	1ASF2350	34,33	1ASFI350	84,59	1ASFI5350	93,05
25	4"	90-110	1ASF400	30,97	1ASF2400	34,68	1ASFI400	86,64		
25		100-120	1ASF450	32,29	1ASF2450	37,45	1ASFI450	93,46	1ASFI5450	102,80
25	5"	110-130	1ASF500	34,04	1ASF2500	38,49	1ASFI500	98,25		
25		120-140	1ASF550	37,09	1ASF2550	41,95	1ASFI550	100,30	1ASFI5550	110,33
25	6"	130-150	1ASF600	38,38	1ASF2600	43,36	1ASFI600	108,88		
25		140-160	1ASF614	39,70	1ASF2614	48,58	1ASFI614	111,28	1ASFI5614	122,40
25		150-170	1ASF615	49,68	1ASF2615	51,57	1ASFI615	117,11		
25		160-180	1ASF616	55,93	1ASF2616	60,19	1ASFI616	131,84	1ASFI5616	145,02
25		170-190	1ASF617	59,93	1ASF2617	69,31	1ASFI617	139,83		
20		180-200	1ASF618	63,92	1ASF2618	82,07	1ASFI618	149,81	1ASFI5618	164,80
20		190-210	1ASF619	65,92	1ASF2619	94,84	1ASFI619	186,29		
20		200-220	1ASF620	109,86	1ASF2620	120,37	1ASFI620	197,58		
20		210-230	1ASF621	118,55	1ASF2621	124,19	1ASFI621	208,87		
20		220-240	1ASF622	129,84	1ASF2622	132,04	1ASFI622	214,52		
20		230-250	1ASF623	139,83	1ASF2623	158,49	1ASFI623	220,16		
20		240-260	1ASF624	151,81	1ASF2624	167,97	1ASFI624	225,81		

Recomendação Resistência Recommendation Resistance Recommandation Résistance	W1	W2	W4	W5
	4,5Nm	5Nm	5,5Nm	5,5Nm

W1	Totalmente Zincado/ Fully Zinc Plated Steel / Entièrement en Acier Zingué / Acero Cincado
W2	Fita e Cabeça Inox AISI 430 e PF Zincado/Band & Head in AISI 430 & Zinc Plated Screw/Bande et Tête en Acier inox 430 et vis acier Zingué
W4	Totalmente em Inox AISI 304 / Fully Stainless AISI 304 / Entièrement en Acier Inox AISI 304 / Acero Inoxidable AISI 304
W5	Totalmente em Inox AISI 316 / Fully Stainless AISI 316 / Entièrement en Acier Inox AISI 316 / Acero Inoxidable AISI 316

CHAVE FLEXIVEL PROFISSIONAL**PROFESSIONAL FLEXIBLE KEY****CLÉ FLEXIBLE PROFESSIONNEL****CLAVE FLEXIBLE PROFESIONAL**

Medida / Size / Measure	Code / Price / Prix Código € / 1PCS
Hexagonal 6mm - Ab Fita 7,5 e 8mm	2CFN6 9,52
Hexagonal 7mm - Ab Fita 9 e 12mm	2CFN 9,52



ABRAÇADEIRA MINI - NORMA DIN 3017

MINI - NORMA CLAMP DIN 3017

COLLIER MINI-NORMA DIN3017

ABRAZADERA MINI-NORMA DIN 3017



Com PF Hexagonal 6mm / with Hexagonal Screw 6mm / Avec Vis Hexagonale 6mm / Con Tornillo Hexagonal 6mm

Fabricado em Banda 7,5mm

Und Cx	Medida Size Measure	W1		W2		W4	
		Code / Price / Prix Código €/100PCS		Code / Price / Prix Código €/100PCS		Code / Price / Prix Código €/100PCS	
100	8-12			1AMN0812	34,24		
100	10-16			1AMN1016	55,03		
100	12-18			1AMN1218	57,36		

ABRAÇADEIRA NORMA DIN 3017

NORMA CLAMP DIN 3017

COLLIER NORMA DIN 3017

ABRAZADERA NORMA DIN 3017



Com PF Hexagonal 7mm / with Hexagonal Screw 7mm / Avec Vis Hexagonale 7mm / Con Tornillo Hexagonal 7mm

Fabricado em Banda 9mm

Und Cx	Medida Size Measure	Aperto Range Serrage	W1		W2		W4	
			Code / Price / Prix Código €/100PCS		Code / Price / Prix Código €/100PCS		Code / Price / Prix Código €/100PCS	
100	3/16	8-16	1ANE10316	28,25	1ANE0316	31,69	1ANEI0316	137,34
100	3/8	12-22	1ANE1038	42,02	1ANE038	32,44	1ANEI038	149,38
100	1/2	16-27	1ANE1050	46,63	1ANE050	34,87	1ANEI050	155,40
100	3/4	20-32	1ANE1075	51,09	1ANE075	38,05	1ANEI075	162,65
100	7/8	23-35	1ANE1078	55,01	1ANE078	40,42	1ANEI078	178,29
100	1"	25-40	1ANE1100	55,16	1ANE100	41,22	1ANEI100	179,50
100	1 1/4	30-45	1ANE1125	58,59	1ANE125	43,58	1ANEI125	193,95
50	1 1/2	32-50	1ANE1150	61,76	1ANE150	45,18	1ANEI150	207,19
50	1 3/4	40-60	1ANE1175	68,92	1ANE175	50,71	1ANEI175	213,23
50	2"	50-70	1ANE1200	86,91	1ANE200	63,41	1ANEI200	218,03
50	2 1/2	60-80	1ANE1250	96,03	1ANE250	102,59	1ANEI250	226,47
50	3"	70-90	1ANE1300	100,28	1ANE300	104,87	1ANEI300	242,13
50		80-100	1ANE1350	106,98	1ANE350	116,26	1ANEI350	269,86
50	4"	90-110	1ANE1400	141,70	1ANE400	150,45	1ANEI400	314,41
50		100-120	1ANE1450	162,69	1ANE450	171,40	1ANEI450	338,52
50	5"	110-130	1ANE1500	178,46	1ANE500	187,96	1ANEI500	401,17
50	6"	130-150			1ANE600	229,97	1ANEI600	456,57

W1 Totalmente Aluzinc/ Fully Aluzinc / Entièrement en Aluzinc / Aluzinc**W2** Fita e Cabeça Inox AISI 430 e PF Zincado/Band & Head in AISI 430 & Zinc Plated Screw/Bande et Tête en Acier inox 430 et vis acier
Acier inox 430 et vis acier Zingué**W4** Totalmente em Inox AISI 304 / Fully Stainless AISI 304 / Entièrement en Acier Inox AISI 304 / Acero Inoxidable AISI 304

ABRAÇADEIRA NORMA DIN 3017

NORMA CLAMP DIN 3017

COLLIER NORMA DIN 3017

ABRAZADERA NORMA DIN 3017



Com PF Hexagonal 7mm / with Hexagonal Screw 7mm / Avec Vis Hexagonale 7mm / Con Tornillo Hexagonal 7mm

Fabricado em Banda 12mm

Und Cx	Medida Size Measure	Aperto Range Serrage	W1		W2		W4	
			Code / Price / Prix		Code / Price / Prix		Code / Price / Prix	
			Código	€/100PCS	Código	€/100PCS	Código	€/100PCS
50	1/2	16-27	1AN1050	49,47	1AN050	52,51	1ANI050	104,14
50	3/4	20-32	1AN1075	49,57	1AN075	52,56	1ANI075	104,88
50	7/8	23-35			1AN078		1ANI078	
50	1"	25-40	1AN1100	50,96	1AN100	57,35	1ANI100	108,99
50	1 1/4	30-45	1AN1125	53,65	1AN125	57,55	1ANI125	111,77
50	1 1/2	35-50	1AN1150	54,41	1AN150	57,73	1ANI150	112,73
50	1 3/4	40-60	1AN1175	58,27	1AN175	65,36	1ANI175	123,07
25	2"	50-70	1AN1200	61,32	1AN200	67,28	1ANI200	134,74
25	2 1/2	60-80	1AN1250	74,34	1AN250	115,60	1ANI250	153,83
25	3"	70-90	1AN1300	78,18	1AN300	128,03	1ANI300	161,49
25		80-100	1AN1350	84,80	1AN350	132,43	1ANI350	106,87
25	4"	90-110	1AN1400	91,27	1AN400	143,40	1ANI400	182,20
25		100-120	1AN1450	103,79	1AN450	145,61	1ANI450	198,75
25	5"	110-130	1AN1500	114,02	1AN500	158,03	1ANI500	205,45
25		120-140	1AN1550	125,03	1AN550	165,38	1ANI550	212,74
25	6"	130-150	1AN1600	138,82	1AN600	171,94	1ANI600	330,43
25		140-160	1AN1614	148,76	1AN614	179,99	1ANI614	353,05
		150-170	1AN1615	152,38	1AN615	209,98	1ANI615	372,94
		160-180	1AN1616	154,35	1AN616	220,95	1ANI616	400,12
		170-190	1AN1617	163,36	1AN617	240,73	1ANI617	419,09
		180-200	1AN1618	180,27	1AN618	247,34	1ANI618	439,98
		190-210	1AN1619	190,06	1AN619	256,80	1ANI619	458,05
		200-220	1AN1620	204,72	1AN620	265,59	1ANI620	478,87
		210-230	1AN1621	224,29	1AN621	280,96	1ANI621	498,79
		220-240	1AN1622	238,26	1AN622	296,33	1ANI622	521,40
		230-250	1AN1623	269,01	1AN623	316,41	1ANI623	580,93

W1 Totalmente Aluzinc/ Fully Aluzinc / Entièrement en Aluzinc / Aluzinc**W2** Fita e Cabeça Inox AISI 430 e PF Zincado/Band & Head in AISI 430 & Zinc Plated Screw/Bande et Tête en Acier inox 430 et vis acier Zingué**W4** Totalmente em Inox AISI 304 / Fully Stainless AISI 304 / Entièrement en Acier Inox AISI 304 / Acero Inoxidable AISI 304

ABRAÇADEIRA MINI-FLEX

MINI-FLEX CLAMP

COLLIER MINI-FLEX

ABRAZADERA MINI-FLEX



Fabricado em Banda 5mm

Und Cx	Medida Size Mesure	W1		W2		W4	
		Code / Price / Prix Código €/100PCS		Code / Price / Prix Código €/100PCS		Code / Price / Prix Código €/100PCS	
50	7-11			1AMF0711	44,79	1AMFI0711	175,49
50	9-14			1AMF0914	46,53	1AMFI0914	176,97
50	10-19			1AMF1019	47,44	1AMFI1019	183,83

ABRAÇADEIRA MINUS

MINUS CLAMP

COLLIER MINUS

ABRAZADERA MINUS



Fabricado em Banda 8mm

Und Cx	Medida Size Mesure	Aperto Range Serrage	W1		W2		W4	
			Code / Price / Prix Código €/100PCS		Code / Price / Prix Código €/100PCS		Code / Price / Prix Código €/100PCS	
50	3/16	8-12	1ASE0316	25,02	1APM0316	15,41	1APMI0316	
50	3/8	10-16	1ASE038	25,11	1APM038	16,12	1APMI038	24,09
50	1/2	14-24	1ASE050	28,31	1APM050	18,41	1APMI050	26,00
50	3/4	18-28	1ASE075	28,75	1APM075	19,46	1APMI075	27,67
25	1"	24-36	1ASE100	32,87	1APM100	22,37	1APMI100	30,24
25	1 1/4	25-45	1ASE125	34,00	1APM125	24,17	1APMI125	32,26
25	1 1/2	32-52	1ASE150	36,91	1APM150	26,55	1APMI150	34,64
25	2"	40-60	1ASE200	41,19	1APM200	28,24	1APMI200	36,66
25	2 1/2	47-67	1ASE250	51,89	1APM250	29,91	1APMI250	40,42
25	3"	62-82	1ASE300	57,39	1APM300	33,68	1APMI300	42,21
25	4"	77-97			1APM400	35,40		
25	5"	92-112			1APM500	37,55		

Recomendação Resistência
Recommendation Resistance
Recommandation Résistance

W1
2,8Nm

W2
2,8Nm

W4
2,8Nm

W1 Totalmente Aluzinc/ Fully Aluzinc / Entièrement en Aluzinc / Aluzinc

W2 Fita e Cabeça Inox AISI 430 e PF Zincado/Band & Head in AISI 430 & Zinc Plated Screw/Bande et Tête en Acier inox 430 et vis acier Zingué

W4 Totalmente em Inox AISI 304 / Fully Stainless AISI 304 / Entièrement en Acier Inox AISI 304 / Acero Inoxidable AISI 304

ABRAÇADEIRA PERFURADA CABEÇA SOLTA

PERFORATED BAND CLAMP WITH FREE HEAD

COLLIER DE SERRAGE PERFORÉE AVEC TÊTE LIBRE

ABRAZADERA PERFORADA CON CABEZA SUELTA

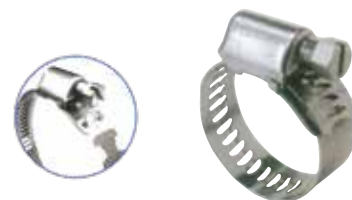

Fabricado em Banda 14mm

Und Cx	Medida Size Measure	Aperto Range Serrage	W1 - MARCA SERFLEX		W2		W4	
			Code / Price / Prix		Code / Price / Prix		Code / Price / Prix	
			Código	€/100PCS	Código	€/100PCS	Código	€/100PCS
25	1/2	000 14-22	1AS050	53,87	1APCS050	56,11		
25	3/4	00 18-28	1AS075	53,87	1APCS075	56,11		
25	1"	0 24-36	1AS100	55,49	1APCS100	58,15		
25	1 1/4	0A 25-45	1AS125	58,42	1APCS125	60,74		
25	1 1/2	1 32-52	1AS150	59,26	1APCS150	61,98		
25	2"	1A 40-60	1AS200	63,45	1APCS200	66,05		
25	2 1/2	2 47-67	1AS250	66,77	1APCS250	69,55		
25	3"	3 62-82	1AS300	80,96	1APCS300	84,11		
25	4"	4 77-97	1AS400	85,12	1APCS400	86,94		
25	5"	5 92-112	1AS500	104,10	1APCS500	107,26		
25	6"	107-127	1AS600	116,36				
25	7"	122-142	1AS700	124,57				
25	8"	137-157	1AS800	140,88				

ABRAÇADEIRA PERFURADA CABEÇA FIXA

PERFORATED BAND CLAMP WITH FIXED HEAD

COLLIER DE SERRAGE PERFORÉE AVEC TÊTE FIXE

ABRAZADERA PERFORADA CON CABEZA FIJA



Fabricado em Banda 13mm

Und Cx	Medida Size Measure	Aperto Range Serrage	W1		W2		W4	
			Code / Price / Prix		Code / Price / Prix		Code / Price / Prix	
			Código	€/100PCS	Código	€/100PCS	Código	€/100PCS
25	1/2	14-22			1APCF050	33,72	1APCFI050	47,51
25	3/4	18-28			1APCF075	35,72	1APCFI075	48,98
25	1"	24-36			1APCF100	39,36	1APCFI100	52,31
25	1 1/4	25-45			1APCF125	42,72	1APCFI125	55,40
25	1 1/2	32-52			1APCF150	45,57	1APCFI150	57,98
25	2"	40-60			1APCF200	50,02	1APCFI200	59,96
25	2 1/2	47-67			1APCF250	51,91	1APCFI250	61,86
25	3"	62-82			1APCF300	53,45	1APCFI300	65,25
25	4"	77-97			1APCF400	58,30	1APCFI400	69,62
25	5"	92-112			1APCF500	65,60	1APCFI500	76,31
25	6"	107-127			1APCF600	71,24	1APCFI600	81,87
25	7"	122-142			1APCF700	78,75	1APCFI700	84,08
25	8"	137-157			1APCF800	86,28	1APCFI800	91,67
		152-172			1APCF900	90,29	1APCFI900	114,54
		167-187			1APCF916	100,04	1APCFI916	115,82
		182-202			1APCF918	102,91	1APCFI918	121,63
		197-217			1APCF919	103,60	1APCFI919	123,40
		212-232			1APCF921	104,67	1APCFI921	128,70
		227-247			1APCF922	106,11	1APCFI922	132,36

Recomendação Resistência
Recommendation Resistance
Recommandation Résistance

W1
Ø14-22 a 18-28 : 4Nm
Ø24-36 a 137-157 : 5Nm

W2
Ø14-22 a 18-28 : 4Nm
Ø24-36 a 137-157 : 5Nm

W4
Ø14-22 a 18-28 : 4Nm
Ø24-36 a 137-157 : 5Nm

W1 Totalmente Aluzinc/ Fully Aluzinc / Entièrement en Aluzinc / Aluzinc

W2 Fita e Cabeça Inox AISI 430 e PF Zincado/Band & Head in AISI 430 & Zinc Plated Screw/Bande et Tête en Acier inox 430 et vis acier Zingué

W4 Totalmente em Inox AISI 304 / Fully Stainless AISI 304 / Entièrement en Acier Inox AISI 304 / Acero Inoxidable AISI 304

ABRAÇADEIRA ABA SS 2298

ABA CLAMP SS 2298

COLLIER ABA SS 2298

ABRAZADERA ABA SS 2298

**Fabricado em Banda 9mm**

Und Cx	Medida Size Mesure	Aperto Range Serrage	W1		W2		W4	
			Code / Price / Prix		Code / Price / Prix		Code / Price / Prix	
			Código	€/100PCS	Código	€/100PCS	Código	€/100PCS
50		8-14	1AABOE012	48,96			1AABOEI012	191,13
50	3/16	11-17	1AABOE316	49,98			1AABOEI0316	191,13
50	3/8	13-20	1AABOE038	51,00			1AABOEI038	192,79
50	1/2	15-24	1AABOE050	58,15			1AABOEI050	193,39
50	3/4	19-28	1AABOE075	61,19			1AABOEI075	194,27
50	7/8	22-32	1AABOE078	63,75			1AABOEI078	195,32
50	1"	26-38	1AABOE100	64,26			1AABOEI100	196,97
50	1 1/4	32-44	1AABOE125	71,40				
50	1 1/2	38-50	1AABOE150	72,43				
50	1 3/4	44-56	1AABOE175	75,98				
50	2"	50-65	1AABOE200	82,61				
50	2 1/2	58-75	1AABOE250	91,80				
50	3"	68-85	1AABOE300	93,85				

Fabricado em Banda 12mm

Und Cx	Medida Size Mesure	Aperto Range Serrage	W1		W2		W4	
			Code / Price / Prix		Code / Price / Prix		Code / Price / Prix	
			Código	€/100PCS	Código	€/100PCS	Código	€/100PCS
50	1/2	15-24	1AABO050	62,52			1AABOI050	213,53
50	3/4	19-28	1AABO075	65,59			1AABOI075	215,79
50	7/8	22-32	1AABO078	69,19			1AABOI078	219,74
50	1"	26-38	1AABO100	69,70			1AABOI100	222,00
50	1 1/4	32-44	1AABO125	76,89			1AABOI125	240,07
50	1 1/2	38-50	1AABO150	77,89			1AABOI150	244,61
50	1 3/4	44-56	1AABO175	83,03			1AABOI175	275,65
50	2"	50-65	1AABO200	93,29			1AABOI200	296,56
50	2 1/2	58-75	1AABO250	106,61			1AABOI250	302,77
50	3"	68-85	1AABO300	108,15			1AABOI300	323,68
50		77-95	1AABO350	120,43			1AABOI350	362,66
50	4"	87-112	1AABO400	129,66			1AABOI400	398,81
50	5"	104-138	1AABO500	164,74			1AABOI500	449,65
50	6"	130-165	1AABO600	193,41			1AABOI600	529,47
50		150-180	1AABO615	231,86			1AABOI615	615,15
50		175-205	1AABO617	262,37			1AABOI617	710,05
50		200-231	1AABO620	292,87			1AABOI620	794,77
50		226-256	1AABO622	326,43			1AABOI622	912,27

W1 Totalmente Aluzinc/ Fully Aluzinc / Entièrement en Aluzinc / Aluzinc**W4** Totalmente em Inox AISI 304 / Fully Stainless AISI 304 / Entièrement en Acier Inox AISI 304 / Acero Inoxidable AISI 304

ABRAÇADEIRA CABEÇA BASCULANTE

HEAD TIPPER CLAMP

COLLIERS DE SERRAGE À TÊTE BASCULANT

ABRAZADERA CON CABEZA BASCULANTE



Fabricado em Banda 9mm

Und Cx	Medida Size Mesure	W1		W2		W4	
		Code / Price / Prix Código € / 100PCS		Code / Price / Prix Código € / 100PCS		Code / Price / Prix Código € / 100PCS	
100	24-36			1AARE036	29,37		
100	24-44			1AARE044	30,54		
100	32-52			1AARE052	31,89		
100	40-60			1AARE060	33,24		
100	47-67			1AARE067	33,63		
100	62-82			1AARE082	35,19		
25	50-90			1ACB9090	37,74		
25	50-100			1ACB9100	38,99		
25	50-115			1ACB9115	41,50		
25	50-125			1ACB9125	42,43		
25	50-130			1ACB9130	44,03		
25	50-145			1ACB9145	45,92		
25	50-175			1ACB9175	49,35		
25	50-200			1ACB9200	56,45		
25	50-215			1ACB9215	57,56		
25	50-290			1ACB9290	68,24		
25	50-320			1ACB9320	71,38		
25	50-370			1ACB9370	78,60		
25	50-420			1ACB9420	88,98		
25	50-540			1ACB9540	107,23		
25	50-650			1ACB9650	127,97		
25	50-750			1ACB9750	150,29		

W2

Fita e Cabeça Inox AISI 430 e PF Zincado/Band & Head in AISI 430 & Zinc Plated Screw/Bande et Tête en
Acier inox 430 et vis acier Zingué

W4

Totalmente em Inox AISI 304 / Fully Stainless AISI 304 / Entièrement en Acier Inox AISI 304 / Acero Inoxidable AISI 304

ABRAÇADEIRA PLANA 9MM

FLAT CLAMP

COLLIER PLATE 9 MM

ABRAZADERA PLANA 9 MM



Fabricado em banda 9mm

Units/ Box	Size / Maß	W1		W2		W4	
	Medida / Measure	Code / Price / Prix		Code / Price / Prix		Code / Price / Prix	
		Código	€/100PCS	Código	€/100PCS	Código	€/100PCS
100	20-32					2APSFEI	22,58

ABRAÇADEIRA PARA TUBO ESPIRAL

SPIRAL PIPE CLAMPS

COLLIERS SPIRALE

ABRAZADERA ESPIRAL



PONTE LADO ESQUERDO

Bridge left Side

Pont à gauche

Puente lado izquierdo



PONTE LADO DIREITO

Bridge right side

Pont à droite

Puente lado derecho

Units/ Box	Size / Maß Medida / Measure	Banda 9mm		Banda 12mm			
		W2		W2		W4	
		Code / Price / Prix Código	€/100PCS	Code / Price / Prix Código	€/100PCS	Code / Price / Prix Código	€/100PCS
50	40-60	1TE9240	32,90	1TE240	38,32		
50	50-70	1TE9260	34,70	1TE260	40,77		
50	60-80	1TE9270	36,50	1TE270	42,85		
50	70-90	1TE9280	37,58	1TE280	44,24		
50	80-100	1TE92110	38,66	1TE2110	45,62		
50	90-110	1TE92130	39,38	1TE2130	45,97		
50	100-120	1TE92140	41,18	1TE2140	48,74		
50	110-130	1TE92150	41,90	1TE2150	49,78		
50	120-140	1TE92170	44,78	1TE2170	53,24		
50	130-150			1TE2180	54,65		
50	140-160			1TE2200	59,87		
50	150-170			1TE2220	62,86		
50	160-180			1TE2240	71,48		

W2

Fita e Cabeça Inox AISI 430 e PF Zincado/Band & Head in AISI 430 & Zinc Plated Screw/Bande et Tête en Acier inox 430 et vis acier Zingué

W4

Totalmente em Inox AISI 304 / Fully Stainless AISI 304 / Entièrement en Acier Inox AISI 304 / Acero Inoxidable AISI 304

FITA PERFURADA EM BLISTER

PERFORATED BAND IN BLISTER

BANDE PERFORÉE EN BLISTER

CINTA PERFORADA EN BLISTER



Blister	
Fita Band/Bande	Cabeças Head/Tête
3 Metros	8
3 Metros	6

Medida Size Measure
8mm
13mm

W2	
Code / Price / Prix	
Código	€/Blister
1FS08	3,39
1FS13	4,52

W4	
Code / Price / Prix	
Código	€/Blister
1FSI08	4,52
1FSI13	6,32

ROLO FITA PERFURADA

PERFORATED BAND IN ROLL

ROULEAU EN BANDE PERFORÉE

CINTA PERFORADA EN ROLO



Und Cx
30 Metros
30 Metros

Medida Size Measure
8mm
13mm

W4	
Code / Price / Prix	
Código	€/Rolo
1FPCI08	21,08
1FPCI13	32,74

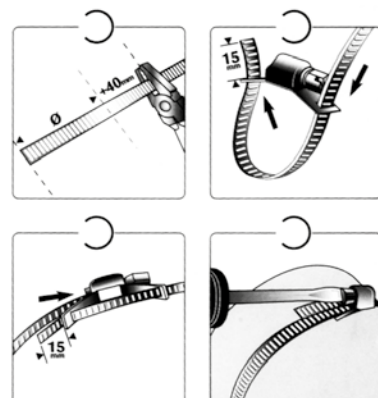

CABEÇA PARA FITA PERFURADA

HEAD FOR PERFORATED BAND

TÊTE POUR BANDE PERFORÉE

CABEZA PARA CINTA PERFORADA



Und Cx
100
100

Medida Size Measure
8mm
13mm

W2	
Code / Price / Prix	
Código	€/100PCS
1CFPC08	12,42
1CFPC13	21,45

W4	
Code / Price / Prix	
Código	€/100PCS
1CFPCI08	21,45
1CFPCI13	42,90



W2

Fita e Cabeça Inox AISI 430 e PF Zincado/Band & Head in AISI 430 & Zinc Plated Screw/Bande et Tête en Acier inox 430 et vis acier Zingué

W4

Totalmente em Inox AISI 304 / Fully Stainless AISI 304 / Entièrement en Acier Inox AISI 304 / Acero Inoxidable AISI 304

ROLO FITA NB-G

NB-G ROLLS OF TAPE

ROULEAU EN BANDE NB-G

ROLLOS DE CINTA NB-G

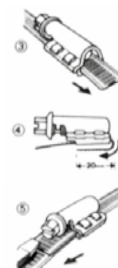

Und Cx
30 Metros

Medida Size Measure
12mm x 0,8mm

W1	
Code / Price / Prix	
Código	€/Rolo
1FNBGS	44,65

W4	
Code / Price / Prix	
Código	€/Rolo
1FNBGS1	61,92

CABEÇA NB-G

NB-G HEAD

TÊTE NB-G

CABEZAS NB-G



NB-G

Und Cx
50

Medida Size Measure
12mm

W1	
Code / Price / Prix	
Código	€/100PCS
1CNBGS	114,82

W4	
Code / Price / Prix	
Código	€/100PCS
1CNBGS1	128,78

ROLO FITA NÃO PERFURADA

NOT PERFORATED ROLL TAPE

ROULEAU EN BANDE NON PERFORÉES

CINTA EN ROLO NO PERFORADA



Und Cx
30 Metros
30 Metros

Medida Size Measure
9mm
12mm

W2	
Code / Price / Prix	
Código	€/Rolo
1RFNP9	11,88
1RFNP12	14,29

W4	
Code / Price / Prix	
Código	€/Rolo
1RFNPI9	21,16
1RFNPI12	29,69

CABEÇA PARA FITA NÃO PERFURADA

HEAD FOR TAPE NOT PERFORATED

TÊTE POUR BANDE NON PERFORÉES

CABEZA PARA CINTA NO PERFORADA



Und Cx
50
50

Medida Size Measure
9mm
12mm

W2	
Code / Price / Prix	
Código	€/100PCS
1CFNP9	23,06
1CFNP12	34,49

W4	
Code / Price / Prix	
Código	€/100PCS
1CFNPI9	40,93
1CFNPI12	51,94

W2

Fita e Cabeça Inox AISI 430 e PF Zincado/Band & Head in AISI 430 & Zinc Plated Screw/Bande et Tête en Acier inox 430 et vis acier Zingué

W4

Totalmente em Inox AISI 304 / Fully Stainless AISI 304 / Entièrement en Acier Inox AISI 304 / Acero Inoxidable AISI 304

ROLO FITA NB-D

NB-D ROLL TAPE

ROULEAU EN BANDE NB-D

ROLLOS DE CINTA NB-D



Und Cx	Medida / Size / Mesure	
	Largura width / Largeur	Espessura Thickness
30 Metros	9,5-3/8	0,55
30 Metros	13-1/2	0,8
30 Metros	15,8-5/8	0,8
30 Metros	19-3/4	0,8

W4	
Code / Price / Prix	
Código	€/Rolo
1FNBD95	14,75
1FNBD13	26,44
1FNBD158	31,98
1FNBD19	37,34

CABEÇA NB

NB HEAD

TÊTE NB

CABEZAS NB

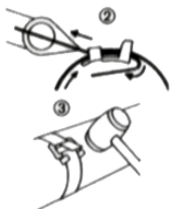

Und Cx	Medida Size Measure	NB-D	NB-H	
		Referência Reference Référence	W1	
			Code / Price / Prix	
			Código	€/100PCS
100	9,5-3/8	Cabeça NB-D		
100	13-1/2	Cabeça NB-D		
100	15,8-5/8	Cabeça NB-D		
100	19-3/4	Cabeça NB-D		
20	13/16/19	Cabeça NB-H	1CNBH	628,35

MAQUINA PARA FITA NB-D

NB-D MACHINE TAPE

MACHINE POUR BANDE NB-D

MÁQUINA PARA CINTA NB-D



W4	
Code / Price / Prix	
Código	€/100PCS
1CNBD95	13,55
1CNBD13	18,06
1CNBD158	27,10
1CNBD19	31,61

Code / Price / Prix	
Código	€/1PCS
1MNBD	95,30

GANCHOS DE SOLDAR

HOOK WELDING

HOOK SOUDAGE

GANCHO DE SOLDADURA



Gancho N° 1

Gancho N° 2

Gancho N° 3

Und Cx	Medida Size Measure	Referência Reference Référence
20	9	Gancho N° 1
20	9	Gancho N° 2
20	9	Gancho N° 3

W4	
Code / Price / Prix	
Código	€/100PCS
1GS1	44,03
1GS2	59,84
1GS3	203,23

W4	
Code / Price / Prix	
Código	€/100PCS
1GS1	44,03
1GS2	59,84
1GS3	203,23

W1

Totalmente Zincado/ Fully Zinc Plated Steel / Entièrement en Acier Zingué / Acero Cincado

W4

Totalmente em Inox AISI 304 / Fully Stainless AISI 304 / Entièrement en Acier Inox AISI 304 / Acero Inoxidable AISI 304

ROLO FITA ONDULADA

WAVY ROLL TAPE

ROULEAU EN BANDE ONDULÉ

ROLLO CINTA ONDULADA

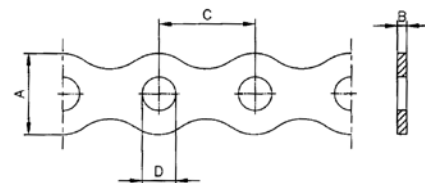

Units/Box	Size / Maß Medida / Mesure	A (mm)	B (mm)	C (mm)	D (mm)	W1		W4	
						Code / Price / Prix Código €/Rolo		Code / Price / Prix Código €/Rolo	
10 Metros	12	12	0,8	14	5	1RFP12	2,39	1RFPI12	7,98
10 Metros	17	17	0,8	20	7	1RFP17	3,11	1RFPI17	9,12

ROLO FITA RECTA

STRAIGHT ROLL TAPE

ROULEAU BANDE DROITE

ROLLO CINTA RECTA

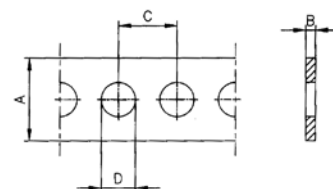
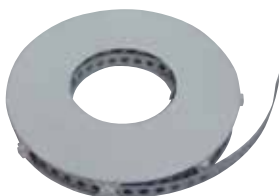

Units/Box	Size / Maß Medida / Mesure	A (mm)	B (mm)	C (mm)	D (mm)	W1		W4	
						Code / Price / Prix Código €/Rolo		Code / Price / Prix Código €/Rolo	
10 Metros	12	12	0,8	14	5	1RFPR	2,63		
10 Metros	17	17	0,8	20	7	1RFPR17	3,35		
10 Metros	25	25	1,0	25	9	1RFPR25	5,37		

ROLO FITA RECTA MULTI-FURO

STRAIGHT MULTI - HOLE ROLL TAPE

ROULEAU BANDE DROITE MULTI TROUS

ROLO DE CINTA RECTA MULTI-FURO

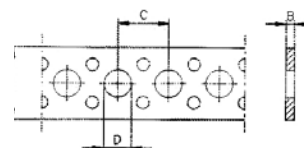

Units/Box	Size / Maß Medida / Mesure	A (mm)	B (mm)	C (mm)	D (mm)	W1		W4	
						Code / Price / Prix Código €/Rolo		Code / Price / Prix Código €/Rolo	
10 Metros	17	17	0,7	12	6	1RFPFR17	3,35		
10 Metros	25	25	1,0	14		1RFPFR25	5,39		

W1

Totalmente Zincado/ Fully Zinc Plated Steel / Entièrement en Acier Zingué / Acero Cincado

W4

Totalmente em Inox AISI 304 / Fully Stainless AISI 304 / Entièrement en Acier Inox AISI 304 / Acero Inoxidable AISI 304

ABRAÇADEIRA TIPO "L" ISOFÓNICA DIN 3016

ISOPHONIC CLAMP TYPE "L" DIN 3016

COLLIER ISOPHONIQUE TYPE "L" DIN 3016

ABRAZADERA ISOFÓNICA TIPO "L" DIN 3016

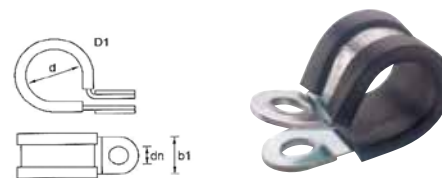
**B1:** Banda 15/20/25mm**DN:** Furo Ø 6,4, Ø 8,4, Ø 10,5mm

Und Cx	Ø (mm)	W1					
		Banda 15mm		Banda 20mm		Banda 25mm	
		Code / Price / Prix		Code / Price / Prix		Code / Price / Prix	
		Código	€/100PCS	Código	€/100PCS	Código	€/100PCS
50	6	1LFA06	11,50				
50	8	1LFA08	11,50				
50	10	1LFA10	11,85				
50	12	1LFA12	13,29				
50	14	1LFA14	13,99	1LFA814	20,47	1LFA214	22,61
50	16	1LFA16	15,09	1LFA816	20,46	1LFA216	23,70
50	18	1LFA18	15,79	1LFA818	21,54	1LFA218	24,77
50	20	1LFA20	16,53	1LFA820	22,26	1LFA220	25,49
50	22	1LFA22	17,23	1LFA822	23,33	1LFA222	26,92
50	24	1LFA24	17,95	1LFA824	24,77	1LFA224	28,36
50	25	1LFA26	19,02				
50	26	1LFA25	19,02	1LFA825	25,84	1LFA225	29,80
25	28	1LFA28	20,46	1LFA828	27,29	1LFA228	31,24
25	30	1LFA30	21,54	1LFA830	28,36	1LFA230	32,67
25	32	1LFA32	22,61	1LFA832	29,43	1LFA232	33,74
25	34	1LFA34	23,70	1LFA834	30,52	1LFA234	34,83
25	36	1LFA36	24,40	1LFA836	31,59	1LFA236	35,90
25	38	1LFA38	25,49	1LFA838	32,67	1LFA238	36,97
25	40	1LFA40	26,57	1LFA840	33,74	1LFA240	38,07
20	42	1LFA42	28,01	1LFA842	34,83	1LFA242	39,14
20	44	1LFA44	29,08	1LFA844	36,27	1LFA244	40,21
10	46	1LFA46	30,52	1LFA846	37,69	1LFA246	41,30
10	48	1LFA48	32,32	1LFA848	39,14	1LFA248	42,35
10	50	1LFA50	34,46	1LFA850	40,93	1LFA250	43,44

Und Cx	Ø (mm)	W4					
		Banda 15mm		Banda 20mm		Banda 25mm	
		Code / Price / Prix		Code / Price / Prix		Code / Price / Prix	
		Código	€/100PCS	Código	€/100PCS	Código	€/100PCS
50	6	1LFAI06	22,90				
50	8	1LFAI08	23,35				
50	10	1LFAI10	24,42				
50	12	1LFAI12	25,51				
50	14	1LFAI14	26,59	1LFAI814	30,87	1LFAI214	36,60
50	16	1LFAI16	28,75	1LFAI816	31,94	1LFAI216	38,39
50	18	1LFAI18	30,54	1LFAI818	33,74	1LFAI218	40,19
50	20	1LFAI20	31,61	1LFAI820	35,20	1LFAI220	41,63
50	22	1LFAI22	33,04	1LFAI822	37,34	1LFAI222	43,77
50	24	1LFAI24	34,48	1LFAI824	39,16	1LFAI224	45,57
50	26	1LFAI26	35,94	1LFAI825	41,32	1LFAI225	47,38
25	28	1LFAI28	36,62	1LFAI828	43,82	1LFAI228	49,17
25	30	1LFAI30	38,09	1LFAI830	45,28	1LFAI230	50,60
25	32	1LFAI32	39,86	1LFAI832	46,70	1LFAI232	52,76
25	34	1LFAI34	42,04	1LFAI834	48,84	1LFAI234	55,27
25	36	1LFAI36	43,82	1LFAI836	51,01	1LFAI236	57,77
25	38	1LFAI38	44,56	1LFAI838	53,17	1LFAI238	59,93
25	40	1LFAI40	45,61	1LFAI840	54,59	1LFAI240	62,07
20	42	1LFAI42	47,05	1LFAI842	56,04	1LFAI242	64,24
20	44	1LFAI44	48,51	1LFAI844	57,48	1LFAI244	66,75
10	46	1LFAI46	50,29	1LFAI846	59,62	1LFAI246	68,55
10	48	1LFAI48	51,73	1LFAI848	60,71	1LFAI248	70,34
10	50	1LFAI50	53,17	1LFAI850	61,79	1LFAI250	72,85

W1 Totalmente Zincado/ Fully Zinc Plated Steel / Entièrement en Acier Zingué / Acero Cincado**W4** Totalmente em Inox AISI 304 / Fully Stainless AISI 304 / Entièrement en Acier Inox AISI 304 / Acero Inoxidable AISI 304

ABRAÇADEIRA DE ARAME

WIRE CLAMPS

COLLIER FIL

ABRAZADERA ALAMBRE



Units/ Box	Aperto	Chapa	Arame	Parafuso	W1		W4	
	Range	Band	Wire	Screw	Code / Price / Prix		Code / Price / Prix	
	Serrage	Bande	Fil	Vis	Código	€/100PCS	Código	€/100PCS
50	13-16	16x9x3	1,8	M5x35	1AA1316	11,04	1AAI1316	40,61
50	15-18	16x9x3	1,8	M5x35	1AA1518	11,04	1AAI1518	40,61
50	17-21	16x9x3	1,8	M5x35	1AA1721	12,57	1AAI1720	40,61
50	19-22	16x9x3	1,8	M5x35	1AA1922	12,57	1AAI1922	40,61
50	20-24	16x9x3	1,8	M5x35	1AA2024	12,57	1AAI2024	40,61
50	22-26	16x9x3	1,8	M5x35	1AA2226	12,57	1AAI2226	40,61
50	24-28	16x9x3	1,8	M5x35	1AA2428	12,57	1AAI2428	41,76
50	26-30	18x10x4	2	M6x40	1AA2630	16,72	1AAI2630	47,75
50	31-35	18x10x4	2	M6x40	1AA3135	16,72	1AAI3135	47,75
50	34-38	18x10x4	2	M6x40	1AA3438	16,72	1AAI3438	47,75
50	35-40	18x10x4	2	M6x40	1AA3540	17,50	1AAI3540	51,52
50	37-42	18x10x4	2	M6x40	1AA3742	17,50	1AAI3742	51,52
50	40-45	18x10x4	2	M6x40	1AA4045	17,50	1AAI4045	51,52
25	45-50	18x10x4	2	M6x50	1AA4550	20,51	1AAI4550	59,05
25	50-55	18x10x4	2	M6x50	1AA5055	20,51	1AAI5055	61,28
25	55-60	18x10x4	2	M6x60	1AA5560	20,90	1AAI5560	65,05
25	60-65	18x10x4	2	M6x60	1AA6065	22,80	1AAI6065	65,05
25	65-70	18x10x4	2,4	M6x60	1AA6570	25,84	1AAI6570	69,20
25	70-75	18x10x4	2,4	M6x60	1AA7075	25,84	1AAI7075	69,20
25	75-80	18x10x4	2,4	M6x60	1AA7580	27,73	1AAI7580	73,70
25	80-85	18x10x4	2,4	M6x60	1AA8085	27,73	1AAI8085	73,70
25	85-90	18x10x4	2,4	M6x60	1AA8590	37,26	1AAI8590	77,07
25	90-95	18x10x4	2,4	M6x60	1AA9095	37,26	1AAI9095	77,07
25	95-100	18x10x4	2,4	M6x70	1AA9510	39,16	1AAI9510	77,46
25	107-120	18x10x4	2,4	M6x70	1AA107	42,20		
25	115-125	22x12x4	3	M8x90	1AA112	45,99	1AAI115	118,28
25	117-130	22x12x4	3	M8x90	1AA117	46,38		
25	127-140	22x12x4	3	M8x90	1AA127	46,38		
25	135-150	22x12x4	3	M8x90	1AA137	49,42	1AAI135	139,31
25	147-160	22x12x4	3	M8x90	1AA147	49,42		
25	157-170	22x12x4	3	M8x90	1AA157	53,99		
25	165-180	22x12x4	3	M8x90			1AAI165	160,35
25	177-190	22x12x4	3	M8x90	1AA177	58,56		
25	185-200	22x12x4	3	M8x90			1AAI175	169,45
25	247-260	22x12x4	3	M8x90	1AA247	106,32		
25	312-325	22x12x4	3	M8x90	1AA312	148,63		
25	327-410	22x12x4	3	M8x90	1AA327	148,63		
25	497-510	22x12x4	3	M8x90	1AA497	169,35		

W1

Totalmente Zincado/ Fully Zinc Plated Steel / Entièrement en Acier Zingué / Acero Cincado

W4

Totalmente em Inox AISI 304 / Fully Stainless AISI 304 / Entièrement en Acier Inox AISI 304 / Acero Inoxidable AISI 304

ABRAÇADEIRA ESCALA AISI 304

SCALE CLAMP AISI 304

COLLIER SCALE AISI 304

ABRAZADERA ESCALA AISI 304



Und Cx	Medida Size Measure	Medida Nominal Nominal Measure Mesure Nominale	Banda Band Bande	W4	
				Code / Price / Prix	
				Código	€/100PCS
200	7,8-9,5	9,5	7	2ASE095	11,71
200	8,8-10,5	10,5	7	2ASE105	11,71
200	9,4-11,9	11,9	7	2ASE119	11,71
200	9,8-12,3	12,3	7	2ASE123	11,71
200	10,3-12,8	12,8	7	2ASE128	11,71
200	10,8-13,3	13,3	7	2ASE133	11,71
200	11,5-14	14	7	2ASE140	11,71
200	12,3-14,8	14,8	7	2ASE148	11,71
200	13,2-15,7	15,7	7	2ASE157	12,08
200	13,7-16,2	16,2	7	2ASE162	12,98
200	14,5-17,5	17,5	7	2ASE175	12,98
200	15,3-18,50	18,5	7	2ASE185	13,40
200	16-19,2	19,2	7	2ASE192	13,40
200	16,6-19,8	19,8	7	2ASE198	13,60
200	17,8-21	21	7	2ASE21	14,01
200	19,4-22,6	22,6	7	2ASE226	14,33
200	20,3-23,5	23,5	7	2ASE235	15,22
200	20,9-24,1	24,1	7	2ASE241	15,22
200	22,4-25,6	25,6	7	2ASE256	15,68
200	23,9-27,1	27,1	7	2ASE271	15,81
200	25,4-28,6	28,6	7	2ASE286	15,98
200	26,9-30,1	30,1	7	2ASE301	16,13
200	27,6-30,8	30,8	7	2ASE308	16,13
200	28,4-31,6	31,6	7	2ASE316	16,57
200	29,9-33,1	33,1	7	2ASE331	17,03
200	31,4-34,5	34,5	7	2ASE346	17,48
200	39,6	39,6	7	2ASE396	21,66
200	42,5	42,5	7	2ASE425	21,66

ABRAÇADEIRA FOLE CARDAN 7mm AISI 304

FOLES CARDAN CLAMP 7mm AISI 304

COLLIER FOLE CARDAN 7mm AISI 304

ABRAZADERA FOLE CARDAN 7mm AISI 304

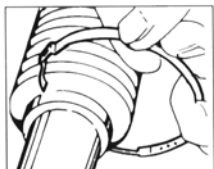

Und Cx	Aperto Range Serrage	Banda Band Bande	W4	
			Code / Price / Prix	
			Código	€/100PCS
100	25-40	7	2AFC25	14,68
100	45-120	7	2AFC45	33,19

W4

Totalmente em Inox AISI 304 / Fully Stainless AISI 304 / Entièrement en Acier Inox AISI 304 / Acero Inoxidable AISI 304

ABRAÇADEIRA FIVELA INOX AISI 304

BUCKLE CLAMP AISI 304

COLLIER FIVELA AISI 304

ABRAZADERA FIVELA AISI 304



Und Cx	Medida Size Mesure	W1		W4	
		Code / Price / Prix		Code / Price / Prix	
		Código	€/100PCS	Código	€/100PCS
25	4,6x200			2AFI200	12,93
25	4,6x300			2AFI300	13,53
25	4,6x350			2AFI350	13,81
25	7,9x400			2AFI400	22,83
25	7,9x500			2AFI500	24,64
25	7,9x550			2AFI550	25,84
10	7,9x700			2AFI7700	35,42
10	7,9x1000			2AFI71000	53,17
10	13x600			2AFI600	52,58
10	13x700			2AFI700	58,58
10	13x1000			2AFI1000	90,53

ABRAÇADEIRA 2 ORELHAS

2 EARL CLAMP

COLLIER 2 OREILLES

ABRAZADERA 2 OREJAS



Und Cx	Medida Size Mesure	Banda Band Bande	W1		W4	
			Code / Price / Prix		Code / Price / Prix	
			Código	€/100PCS	Código	€/100PCS
500	5 - 7	6	1AOM205	5,35	1AOIM205	14,73
500	7 - 9	7	1AOM207	6,78	1AOIM207	18,23
500	9-11	7	1AOM209	6,78	1AOIM209	20,43
500	10-12	7	1AOM210	7,01		
250	11-13	7	1AOM211	7,23	1AOIM211	20,68
250	13-15	7	1AOM213	8,36	1AOIM213	24,75
250	14-17	8	1AOM214	10,47	1AOIM214	26,62
250	15-18	8	1AOM215	10,92	1AOIM215	27,11
250	17-20	8	1AOM217	11,08	1AOIM217	30,77
250	18-21	9	1AOM218	12,13	1AOIM218	32,64
250	20-23	9	1AOM220	13,41	1AOIM220	33,70
100	22-25	9	1AOM222	16,50	1AOIM222	42,66
100	23-27	10	1AOM223	17,56		
100	25-28	10	1AOM225	18,99		
100	28-31	10	1AOM228	20,72		
100	31-34	10	1AOM231	22,98		
100	34-37	10	1AOM234	27,88		
100	37-40	10	1AOM237	31,19		
100	40-43	10	1AOM240	34,58		
100	43-46	10	1AOM243	40,16		

W1

Totalmente Zincado/ Fully Zinc Plated Steel / Entièrement en Acier Zingué / Acero Cincado

W4

Totalmente em Inox AISI 304 / Fully Stainless AISI 304 / Entièrement en Acier Inox AISI 304 / Acero Inoxidable AISI 304

ABRAÇADEIRA 1 ORELHA**1 EARL CLAMP****COLLIER 1 OREILLE****ABRAZADERA 1 OREJA**

Und Cx	Medida Size Mesure	Banda Band Bande	W1		W4	
			Code / Price / Prix		Code / Price / Prix	
			Código	€/100PCS	Código	€/100PCS
500	7-9	6	1AO107	6,42	1AOI107	17,58
500	8-10	6	1AO108	6,42	1AOI108	18,32
500	9-11	6	1AO109	6,42	1AOI109	20,19
500	10-12	6	1AO110	6,66	1AOI110	20,84
500	11-13	6	1AO111	7,38	1AOI111	21,82
500	12-14	7	1AO112	8,80	1AOI112	22,87
500	13-15	7			1AOI113	23,77
500	14-16	7	1AO114	10,07	1AOI114	24,42
500	16-18	7	1AO116	11,58	1AOI116	29,71

ABRAÇADEIRA 1 ORELHA C/ ANILHA INTERIOR**1 EAR CLAMP WITH RING****COLLIER 1 OREILLE AVEC RONDELLE INTÉRIEURE****ABRAZADERA 1 OREJA CON ARANDELA**

Und Cx	Aperto Range Serrage	Medida Nominal Nominal Measure Mesure nominale	Banda Band Bande	W1		W4	
				Code / Price / Prix		Code / Price / Prix	
				Código	€/100PCS	Código	€/100PCS
250	7,5-8,5	8,5	6	1AO1A07	14,65	1AO1AI07	26,21
250	8,0-9,5	9,5	6	1AO1A08	14,65	1AO1AI08	27,11
250	9-10,5	10,5	6	1AO1A09	14,82	1AO1AI09	29,31
250	10-11,5	11,5	6	1AO1A10	15,47	1AO1AI10	30,20
250	10,5-12,5	12,5	6	1AO1A11	16,20	1AO1AI11	31,83
250	11,5-13,5	13,5	7	1AO1A115	18,15	1AO1AI12	33,54
250	13-15,3	15,3	7	1AO1A13	19,46	1AO1AI13	35,65
250	14-16,3	16,3	7			1AO1AI14	36,31
250	15-17,3	17,3	7	1AO1A15	21,65	1AO1AI15	37,85
250	16-18,3	18,3	7			1AO1AI16	40,86
250	17-19,3	19,3	7			1AO1AI17	41,68

W1

Totalmente Zincado/ Fully Zinc Plated Steel / Entièrement en Acier Zingué / Acero Cincado

W4

Totalmente em Inox AISI 304 / Fully Stainless AISI 304 / Entièrement en Acier Inox AISI 304 / Acero Inoxidable AISI 304

ALICATE ABRAÇADEIRA ORELHA**EAR CLAMP PLIERS****PINCE POUR COLLIER OREILLE****ALICATE ABRAZADERA OREJA**WITHOUT HOLE
SANS TROU
SIN AGUJEROWITH HOLE
AVEC TROU
CON AGUJERO

Sem Buraco	
Code / Price / Prix	
Código	€/100PCS
1A	790,32

Com Buraco	
Code / Price / Prix	
Código	€/100PCS
1AB	846,77

ABRAÇADEIRA GÁS GALP

GALP GAS CLAMP

COLLIER GAZ GALP

ABRAZADERA GAZ GALP



Und Cx	Medida Size Mesure	W1		W4	
		Code / Price / Prix		Code / Price / Prix	
		Código	€/100PCS	Código	€/100PCS
100	16-18	2AGAZG	19,25		
100	18-20	2AGAZG1	20,27		
100	20-22	2AGAZG2	20,84		

ABRAÇADEIRA GÁS

GAS CLAMP

COLLIER GAZ

ABRAZADERA GAS

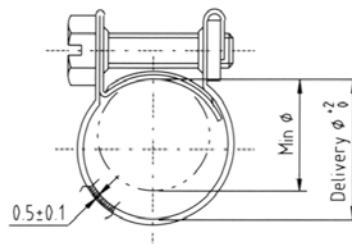

Und Cx	Medida Size Mesure	W1		W4	
		Code / Price / Prix		Code / Price / Prix	
		Código	€/100PCS	Código	€/100PCS
100	6-8	2AGAZ6	10,71	2AGAZI6	31,71
100	7-9	2AGAZ7	10,71	2AGAZI7	31,72
100	8-10	2AGAZ8	10,71	2AGAZI8	31,72
100	9-11	2AGAZ9	10,71	2AGAZI9	32,11
100	10-12	2AGAZ10	10,71	2AGAZI10	32,50
100	11-13	2AGAZ11	10,71	2AGAZI11	32,50
100	12-14	2AGAZ12	10,71	2AGAZI12	32,91
100	13-15	2AGAZ13	11,88	2AGAZI13	33,30
100	14-16	2AGAZ14	11,88	2AGAZI14	33,30
100	15-17	2AGAZ15	11,88	2AGAZI15	34,91
100	16-18	2AGAZ16	11,88	2AGAZI16	35,30
100	17-19	2AGAZ17	13,85	2AGAZI17	41,24
100	18-20	2AGAZ18	13,85	2AGAZI18	41,63
100	19-21	2AGAZ19	13,85	2AGAZI19	42,02
100	20-22	2AGAZ20	13,85	2AGAZI20	43,55
100	21-23	2AGAZ21	13,85	2AGAZI21	43,94
100	22-24	2AGAZ22	13,85	2AGAZI22	44,33
100	23-25	2AGAZ23	13,85	2AGAZI23	44,72
100	24-26	2AGAZ24	13,85	2AGAZI24	45,07
100	25-27	2AGAZ25	13,85	2AGAZI25	45,46
100	26-28	2AGAZ26	13,85	2AGAZI26	45,83
100	27-29	2AGAZ27	13,85	2AGAZI27	46,23
100	28-30	2AGAZ28	13,85	2AGAZI28	46,62
100	29-31	2AGAZ29	15,02	2AGAZI29	47,36
100	30-32	2AGAZ30	15,02	2AGAZI30	47,75
100	31-33	2AGAZ31	15,02	2AGAZI31	47,96
100	32-34	2AGAZ32	15,02	2AGAZI32	48,14

W1

Totalmente Zincado/ Fully Zinc Plated Steel / Entièrement en Acier Zingué / Acero Cincado

W4

Totalmente em Inox AISI 304 / Fully Stainless AISI 304 / Entièrement en Acier Inox AISI 304 / Acero Inoxidable AISI 304

ABRAÇADEIRA HERCULES**HERCULES CLAMP****COLLIER HERCULES****ABRAZADERA HERCULES****W1** Banda / Width / Largeur / Ancho - 19x0,8**W4** Banda / Width / Largeur / Ancho - 20x1

Und Cx	Medida Size Mesure	Aperto Range Serrage	W1		W4	
			Code / Price / Prix		Code / Price / Prix	
			Código	€/100PCS	Código	€/100PCS
50	3/4	27-30	2AH075	38,90	2AHI075	111,37
50	1	33-37	2AH100	39,56	2AHI100	113,59
50	1 1/4	43-47	2AH125	41,14	2AHI125	118,53
50	1 1/2	49-54	2AH150	42,53	2AHI150	123,65
50		55-60	2AH055	43,09	2AHI055	125,39
50		60-65	2AH060	43,63	2AHI060	126,51
50	2	62-67	2AH200	44,00	2AHI200	128,09
50		68-75	2AH068	45,15	2AHI068	131,09
50	2 1/2	77-83	2AH250	46,97	2AHI250	135,13
50		80-86	2AH080	47,57	2AHI080	137,76
50	3	90-96	2AH300	48,79	2AHI300	140,77
50		98-105	2AH098	49,81	2AHI098	143,94
50	4	108-115	2AH400	51,34	2AHI400	148,19
50		114-120	2AH114	52,31	2AHI114	151,09
50	5	137-145	2AH500	55,26	2AHI500	158,79
50		149-161	2AH149	61,29	2AHI149	

**M8****M10**

Units/Box	Rosca Thread Filet	Medida Size Mesure	W1		W4	
			Code / Price / Prix		Code / Price / Prix	
			Código	€/100PCS	Código	€/100PCS
50	M8	32	2AEE32	42,24	2AEEI32	119,41
50	M8	35	2AEE35	42,67	2AEEI35	120,43
50	M8	38	2AEE38	46,74	2AEEI38	134,50
50	M8	40	2AEE40	47,26	2AEEI40	135,92
50	M8	42	2AEE42	48,98	2AEEI42	141,74
50	M8	44	2AEE44	49,50	2AEEI44	143,16
50	M8	45	2AEE45	51,30	2AEEI45	147,69
50	M8	48	2AEE48	52,92	2AEEI48	154,55
50	M8	51/52	2AEE51	54,43	2AEEI51	159,85
50	M8	54	2AEE54	56,20	2AEEI54	166,22
50	M8	57	2AEE57	58,19	2AEEI57	173,66
50	M8	60	2AEE60	60,61	2AEEI60	180,78
50	M8	65	2AEE65	65,97	2AEEI65	200,18
50	M8	70	2AEE70	67,78	2AEEI70	206,13
50	M8	76	2AEE76	71,13	2AEEI76	217,83
50	M10	90	2AEE90	287,48		
50	M10	115	2AEE115	599,12		
50	M10	127	2AEE0127	294,85		
50	M10	140	2AEE140	311,15		

W1 Totalmente Zincado/ Fully Zinc Plated Steel / Entièrement en Acier Zingué / Acero Cincado**W4** Totalmente em Inox AISI 304 / Fully Stainless AISI 304 / Entièrement en Acier Inox AISI 304 / Acero Inoxidable AISI 304

ABRAÇADEIRA SUPER DIN 3017

SUPER CLAMP DIN 3017

COLLIER TOURILLON DIN 3017

ABRAZADERA SUPER DIN 3017

**Banda 18mm Parafuso M5 / Band 18mm Screw M5**

Recommendation resistance - 8Nm

Und Cx	Medida Size Measure	W1		W2		W4		W5	
		Code / Price / Prix Código € / 100PCS		Code / Price / Prix Código € / 100PCS		Code / Price / Prix Código € / 100PCS		Code / Price / Prix Código € / 100PCS	
100	17-19	2AS18017	33,28	2AS18017I2	49,50	2AS18017I4	89,82	2AS18017I	104,62
100	20-22	2AS18020	33,53	2AS18020I2	50,89	2AS18020I4	93,45	2AS18020I	108,67
100	23-25	2AS18023	33,76	2AS18023I2	52,08	2AS18023I4	96,58	2AS18023I	112,14
100	26-28	2AS18026	33,98	2AS18026I2	53,35	2AS18026I4	100,43	2AS18026I	116,41
100	29-31	2AS18029	34,28	2AS18029I2	54,91	2AS18029I4	104,27	2AS18029I	120,68
100	32-35	2AS18032	41,20	2AS18032I2	57,62	2AS18032I4	107,43	2AS18032I	124,19
100	36-39	2AS18036	42,68	2AS18036I2	60,22	2AS18036I4	110,68	2AS18036I	127,81
100	40-43	2AS18040	44,12	2AS18040I2	62,31	2AS18040I4	113,93	2AS18040I	131,42
100	44-47	2AS18044	45,65	2AS18044I2	63,72	2AS18044I4	117,18	2AS18044I	135,01
50	48-51	2AS18048	46,93	2AS18048I2	65,53	2AS18048I4	120,42	2AS18048I	138,63

W1	Totalmente Zincado/ Fully Zinc Plated Steel / Entièrement en Acier Zingué / Acero Cincado
W2	Chapa Inox AISI 304, Taco e Parafuso Zincado / Band in Stainless Steel AISI 304 With Zinc Plated Bolt and Screw
W4	Chapa e Pf Inox AISI 304, Taco Latão Niquelado / Band and Screw in Stainless Steel AISI 304 With Nickel Plated Brass Bolt
W5	Chapa e Pf Inox AISI 316, Taco Latão Niquelado / Band and Screw in Stainless Steel AISI 316 With Nickel Plated Brass Bolt

Banda 20mm Parafuso M6 / Band 20mm Screw M6

Recommendation resistance - 10Nm

Und Cx	Medida Size Measure	W1		W2		W4		W5	
		Code / Price / Prix Código € / 100PCS		Code / Price / Prix Código € / 100PCS		Code / Price / Prix Código € / 100PCS		Code / Price / Prix Código € / 100PCS	
100	23-25	2AS20023	43,84	2AS20023I2	70,27	2AS20023I4	129,08	2AS20023I	164,86
100	26-28	2AS20026	44,45	2AS20026I2	70,40	2AS20026I4	129,33	2AS20026I	165,29
100	29-31	2AS20029	45,05	2AS20029I2	70,52	2AS20029I4	129,58	2AS20029I	165,73
100	32-35	2AS20032	45,65	2AS20032I2	70,65	2AS20032I4	129,83	2AS20032I	166,16
90	36-39	2AS20036	46,25	2AS20036I2	73,52	2AS20036I4	132,66	2AS20036I	170,01
75	40-43	2AS20040	46,39	2AS20040I2	76,48	2AS20040I4	135,58	2AS20040I	174,15
75	44-47	2AS20044	46,55	2AS20044I2	78,59	2AS20044I4	137,67	2AS20044I	177,00
60	48-51	2AS20048	46,84	2AS20048I2	81,14	2AS20048I4	140,20	2AS20048I	180,51
60	52-55	2AS20052	47,43	2AS20052I2	83,65	2AS20052I4	142,68	2AS20052I	184,03
45	56-59	2AS20056	48,24	2AS20056I2	86,40	2AS20056I4	145,96	2AS20056I	184,60
40	60-63	2AS20060	49,13	2AS20060I2	88,76	2AS20060I4	148,29	2AS20060I	187,79
50	64-67	2AS20064	55,02	2AS20064I2	99,23	2AS20064I4	161,27	2AS20064I	201,08
50	68-73	2AS20068	56,14	2AS20068I2	101,89	2AS20068I4	163,90	2AS20068I	204,55
50	74-79	2AS20074	57,13	2AS20074I2	105,11	2AS20074I4	167,34	2AS20074I	209,35
50	80-85	2AS20080	58,20	2AS20080I2	108,54	2AS20080I4	170,99	2AS20080I	214,45
50	86-91	2AS20086	59,49	2AS20086I2	112,70	2AS20086I4	177,74	2AS20086I	222,31
25	92-97	2AS20092	61,05	2AS20092I2	116,43	2AS20092I4	181,41	2AS20092I	227,24
25	98-103	2AS20098	62,42	2AS20098I2	120,00	2AS20098I4	185,09	2AS20098I	232,23
25	104-112	2AS20104	64,93	2AS20104I2	124,79	2AS20104I4	189,83	2AS20104I	238,23

Ensaio de Nêvoa Salina Salt Spray test Test brouillard salin	W1	W2	W4	W5
	72H	72H	240H	400H

W1	Totalmente Zincado/ Fully Zinc Plated Steel / Entièrement en Acier Zingué / Acero Cincado
W2	Chapa Inox AISI 304, Taco e Parafuso Zincado / Band in Stainless Steel AISI 304 With Zinc Plated Bolt and Screw
W4	Chapa, Taco e Parafuso Inox AISI 304, Fully Stainless Steel AISI 304, Entièrement en Acier Inox AISI 304
W5	Chapa, Taco e Parafuso Inox AISI 316, Fully Stainless Steel AISI 316, Entièrement en Acier Inox AISI 316

ABRAÇADEIRA SUPER DIN 3017

SUPER CLAMP DIN 3017

COLLIER TOURILLON DIN 3017

ABRAZADERA SUPER DIN 3017



Banda 25mm Parafuso M8/ Band 25mm Screw M8

Recommendation resistance - 20Nm

Und Cx	Medida Size Mesure	W1		W2		W4		W5	
		Code / Price / Prix Código € / 100PCS		Code / Price / Prix Código € / 100PCS		Code / Price / Prix Código € / 100PCS		Code / Price / Prix Código € / 100PCS	
50	44-47	2AS25044	84,67	2AS25044I2	161,49	2AS25044I4	269,70	2AS25044I	341,34
48	48-51	2AS25048	84,91	2AS25048I2	161,99	2AS25048I4	270,20	2AS25048I	341,99
36	52-55	2AS25052	85,16	2AS25052I2	162,48	2AS25052I4	270,69	2AS25052I	342,64
32	56-59	2AS25056	85,41	2AS25056I2	162,98	2AS25056I4	271,19	2AS25056I	343,29
60	60-63	2AS25060	85,66	2AS25060I2	163,47	2AS25060I4	271,69	2AS25060I	343,94
60	64-67	2AS25064	85,91	2AS25064I2	163,97	2AS25064I4	272,18	2AS25064I	344,59
48	68-73	2AS25068	88,24	2AS25068I2	168,04	2AS25068I4	276,20	2AS25068I	349,83
48	74-79	2AS25074	88,88	2AS25074I2	171,34	2AS25074I4	279,48	2AS25074I	355,41
40	80-85	2AS25080	91,07	2AS25080I2	177,77	2AS25080I4	285,86	2AS25080I	364,26
36	86-91	2AS25086	92,83	2AS25086I2	182,26	2AS25086I4	290,27	2AS25086I	370,80
32	92-97	2AS25092	95,21	2AS25092I2	187,44	2AS25092I4	295,41	2AS25092I	378,10
24	98-103	2AS25098	97,64	2AS25098I2	194,44	2AS25098I4	302,33	2AS25098I	387,21
24	104-112	2AS25104	102,70	2AS25104I2	202,31	2AS25104I4	324,76	2AS25104I	399,98
20	113-121	2AS25113	105,86	2AS25113I2	210,25	2AS25113I4	332,63	2AS25113I	411,08
16	122-130	2AS25122	122,93	2AS25122I2	219,63	2AS25122I4	341,91	2AS25122I	423,65
16	131-139	2AS25131	127,59	2AS25131I2	229,11	2AS25131I4	351,29	2AS25131I	436,09
12	140-148	2AS25140	130,32	2AS25140I2	235,88	2AS25140I4	357,99	2AS25140I	446,16
8	149-161	2AS25149	149,90	2AS25149I2	277,37	2AS25149I4	414,81	2AS25149I	511,06
8	162-174	2AS25162	160,97	2AS25162I2	296,40	2AS25162I4	433,65	2AS25162I	535,27
8	175-187	2AS25175	166,65	2AS25175I2	308,31	2AS25175I4	445,43	2AS25175I	552,23
8	188-200	2AS25188	171,64	2AS25188I2	320,10	2AS25188I4	457,12	2AS25188I	569,68
5	201-213	2AS25201	177,92	2AS25201I2	334,00	2AS25201I4	470,84	2AS25201I	589,20
	214-226	2AS25214	183,52	2AS25214I2	346,50	2AS25214I4	483,23	2AS25214I	607,40
	227-239	2AS25227	199,28	2AS25227I2	370,60	2AS25227I4	507,07	2AS25227I	635,28
	240-255	2AS25240	205,21	2AS25240I2	383,28	2AS25240I4	519,63	2AS25240I	653,58
	250-265	2AS25250	211,36	2AS25250I2	397,17	2AS25250I4	533,62	2AS25250I	671,51
	260-275	2AS25260	218,19	2AS25260I2	406,55	2AS25260I4	542,90	2AS25260I	685,17
	275-290	2AS25275	225,01	2AS25275I2	421,96	2AS25275I4	558,41	2AS25275I	707,12
	290-305	2AS25290	231,59	2AS25290I2	437,44	2AS25290I4	573,75	2AS25290I	728,96
	300-315	2AS25300	232,26	2AS25300I2	438,76	2AS25300I4	575,04	2AS25300I	735,74
	310-325	2AS25310	232,66	2AS25310I2	452,23	2AS25310I4	588,64	2AS25310I	754,95
	320-335	2AS25320	236,10	2AS25320I2	460,10	2AS25320I4	596,40	2AS25320I	765,61
	330-345	2AS25330	240,22	2AS25330I2	470,37	2AS25330I4	606,60	2AS25330I	780,47
	350-365	2AS25350	246,92	2AS25350I2	488,44	2AS25350I4	624,47	2AS25350I	807,04
	360-375	2AS25360	250,30	2AS25360I2	497,47	2AS25360I4	633,40	2AS25360I	820,33
	375-390	2AS25375	255,09	2AS25375I2	511,29	2AS25375I4	647,07	2AS25375I	840,85
	390-405	2AS25390	260,92	2AS25390I2	525,73	2AS25390I4	661,36	2AS25390I	861,71
Ensaio de Nêvoa Salina Salt Spray test Test brouillard salin		W1		W2		W4		W5	
		72H		72H		240H		400H	

W1	Totalmente Zincado/ Fully Zinc Plated Steel / Entièrement en Acier Zingué / Acero Cincado
W2	Chapa Inox AISI 304, Taco e Parafuso Zincado / Band in Stainless Steel AISI 304 With Zinc Plated Bolt and Screw
W4	Chapa, Taco e Parafuso Inox AISI 304, Fully Stainless Steel AISI 304, Entièrement en Acier Inox AISI 304
W5	Chapa, Taco e Parafuso Inox AISI 316, Fully Stainless Steel AISI 316, Entièrement en Acier Inox AISI 316

ABRAÇADEIRA SUPER DIN 3017**SUPER CLAMP DIN 3017****COLLIER TOURILLON DIN 3017****ABRAZADERA SUPER DIN 3017****Banda 30mm Parafuso M10/ Band 30mm Screw M10**

Recommendation resistance -25Nm

Und Cx	Medida Size Measure	W1		W2		W4		W5	
		Code / Price / Prix		Code / Price / Prix		Code / Price / Prix		Code / Price / Prix	
		Código	€/100PCS	Código	€/100PCS	Código	€/100PCS	Código	€/100PCS
10	86-91	2AS30086	180,84	2AS30086I2	295,21	2AS30086I4	385,70	2AS30086I	630,61
10	92-97	2AS30092	184,12	2AS30092I2	302,73	2AS30092I4	393,07	2AS30092I	642,61
10	98-103	2AS30098	188,09	2AS30098I2	311,87	2AS30098I4	402,01	2AS30098I	657,51
10	104-112	2AS30104	193,03	2AS30104I2	321,86	2AS30104I4	411,78	2AS30104I	681,22
10	113-121	2AS30113	197,39	2AS30113I2	332,69	2AS30113I4	422,38	2AS30113I	698,89
10	122-130	2AS30122	203,82	2AS30122I2	346,33	2AS30122I4	435,75	2AS30122I	720,34
10	131-139	2AS30131	211,12	2AS30131I2	360,19	2AS30131I4	449,31	2AS30131I	740,78
10	140-148	2AS30140	216,08	2AS30140I2	371,49	2AS30140I4	460,36	2AS30140I	758,73
5	149-161	2AS30149	231,19	2AS30149I2	393,67	2AS30149I4	482,67	2AS30149I	809,58
5	162-174	2AS30162	245,46	2AS30162I2	417,19	2AS30162I4	505,67	2AS30162I	842,17
5	175-187	2AS30175	252,80	2AS30175I2	433,86	2AS30175I4	521,99	2AS30175I	869,03
5	188-200	2AS30188	259,83	2AS30188I2	450,08	2AS30188I4	537,88	2AS30188I	895,41
5	201-213	2AS30201	268,41	2AS30201I2	467,84	2AS30201I4	555,27	2AS30201I	923,01
5	214-226	2AS30214	274,89	2AS30214I2	484,01	2AS30214I4	571,09	2AS30214I	949,93
5	227-239	2AS30227	287,07	2AS30227I2	505,10	2AS30227I4	591,76	2AS30227I	980,04
5	240-255	2AS30240	293,85	2AS30240I2	521,24	2AS30240I4	610,71	2AS30240I	1013,11
5	250-265	2AS30250	301,17	2AS30250I2	651,96	2AS30250I4	766,52	2AS30250I	1057,97
5	260-275	2AS30260	305,61	2AS30260I2	667,19	2AS30260I4	781,61	2AS30260I	1077,94
5	275-290	2AS30275	311,99	2AS30275I2	689,12	2AS30275I4	803,34	2AS30275I	1106,65
5	290-305	2AS30290	317,87	2AS30290I2	710,71	2AS30290I4	824,75	2AS30290I	1135,18
5	300-315	2AS30300	320,52	2AS30300I2	723,77	2AS30300I4	837,73	2AS30300I	1152,96
5	310-325	2AS30310	325,88	2AS30310I2	739,58	2AS30310I4	853,33	2AS30310I	1173,15
5	320-335	2AS30320	331,81	2AS30320I2	756,93	2AS30320I4	870,45	2AS30320I	1195,23
5	330-345	2AS30330	337,84	2AS30330I2	774,62	2AS30330I4	887,87	2AS30330I	1217,75
5	350-365	2AS30350	347,99	2AS30350I2	804,22	2AS30350I4	917,01	2AS30350I	1255,35
5	360-375	2AS30360	354,54	2AS30360I2	821,65	2AS30360I4	934,13	2AS30360I	1277,15
5	375-390	2AS30375	362,38	2AS30375I2	845,82	2AS30375I4	957,94	2AS30375I	1308,14
5	390-405	2AS30390	369,93	2AS30390I2	868,94	2AS30390I4	980,73	2AS30390I	1337,73
5	405-420	2AS30405	376,72	2AS30405I2	890,67	2AS30405I4	1002,15	2AS30405I	1365,76
5	425-440	2AS30425	385,46	2AS30425I2	920,63	2AS30425I4	1031,69	2AS30425I	1404,71
5	440-455	2AS30440	391,36	2AS30440I2	942,35	2AS30440I4	1053,14	2AS30440I	1433,24
5	450-465	2AS30450	396,13	2AS30450I2	958,27	2AS30450I4	1068,84	2AS30450I	1453,87
5	465-480	2AS30465	402,48	2AS30465I2	980,23	2AS30465I4	1090,46	2AS30465I	1482,42
5	480-495	2AS30480	411,51	2AS30480I2	1004,85	2AS30480I4	1114,68	2AS30480I	1513,29
5	495-510	2AS30495	418,14	2AS30495I2	1027,88	2AS30495I4	1137,34	2AS30495I	1543,26
5	510-525	2AS30510	427,07	2AS30510I2	1052,20	2AS30510I4	1161,21	2AS30510I	1573,68
5	525-540	2AS30525	432,95	2AS30525I2	1073,55	2AS30525I4	1182,86	2AS30525I	1602,21

Ensaio de Nêvoa Salina Salt Spray test Test brouillard salin	W1	W2	W4	W5
	72H	72H	240H	400H

W1	Totalmente Zincado/ Fully Zinc Plated Steel / Entièrement en Acier Zingué / Acero Cincado
W2	Chapa Inox AISI 304, Taco e Parafuso Zincado / Band in Stainless Steel AISI 304 With Zinc Plated Bolt and Screw
W4	Chapa, Taco e Parafuso Inox AISI 304, Fully Stainless Steel AISI 304, Entièrement en Acier Inox AISI 304
W5	Chapa, Taco e Parafuso Inox AISI 316, Fully Stainless Steel AISI 316, Entièrement en Acier Inox AISI 316

ABRAÇADEIRA SUPER DE MOLA

SUPER CLAMP WITH SPRING

COLLIER À RESSORT

ABRAZADERA CON MUELLE



Banda 20x1mm Parafuso M6x80 / Band 20x1mm Screw M6x80

Und Cx	Medida Size Mesure	Mola Normal / Normal Spring / Ressort Normalressort				Mola Reforçada/Reinforced Spring/Ressort Renforcé			
		W1		W2		W1		W2	
		Code / Price / Prix		Code / Price / Prix		Code / Price / Prix		Code / Price / Prix	
		Código	€/100PCS	Código	€/100PCS	Código	€/100PCS	Código	€/100PCS
50	46-53	2ASM048	71,48	2ASM2048	104,61	2ASMR048	77,81	2ASMR2048	110,93
50	52-59	2ASM055	72,34	2ASM2055	105,70	2ASMR055	78,66	2ASMR2055	112,02
50	60-67	2ASM060	75,14	2ASM2060	112,81	2ASMR060	81,46	2ASMR2060	119,13
50	65-72	2ASM064	76,58	2ASM2064	116,39	2ASMR064	82,90	2ASMR2064	122,71
50	71-78	2ASM072	77,90	2ASM2072	119,68	2ASMR072	84,23	2ASMR2072	126,00
50	75-82	2ASM074	79,03	2ASM2074	123,06	2ASMR074	85,35	2ASMR2074	129,39
50	80-87	2ASM080	79,97	2ASM2080	124,81	2ASMR080	86,30	2ASMR2080	131,13
50	83-90	2ASM083	81,25	2ASM2083	127,58	2ASMR083	87,58	2ASMR2083	133,90
50	90-97	2ASM090	81,29	2ASM2090	129,84	2ASMR090	87,61	2ASMR2090	136,16
50	91-98	2ASM091	83,13	2ASM2091	131,30	2ASMR091	89,45	2ASMR2091	137,63
50	92-99	2ASM092	83,55	2ASM2092	132,10	2ASMR092	89,87	2ASMR2092	138,42
50	96-103	2ASM094	86,33	2ASM2094	135,79	2ASMR094	92,65	2ASMR2094	142,11
50	99-106	2ASM098	86,94	2ASM2098	137,74	2ASMR098	93,26	2ASMR2098	144,06
50	102-109	2ASM099	88,94	2ASM2099	140,55	2ASMR099	95,26	2ASMR2099	146,87
50	103-110	2ASM100	91,14	2ASM2100	143,66	2ASMR100	97,46	2ASMR2100	149,98
50	115-122	2ASM106	94,03	2ASM2106	149,61	2ASMR106	100,36	2ASMR2106	155,93
50	122-129	2ASM122	97,04	2ASM2122	155,91	2ASMR122	103,37	2ASMR2122	162,24
50	128-135	2ASM128	100,10	2ASM2128	162,32	2ASMR128	106,42	2ASMR2128	168,64
50	134-141	2ASM120	103,87	2ASM2120	167,85	2ASMR120	110,19	2ASMR2120	174,18
50	136-143	2ASM136	110,08	2ASM2136	173,31	2ASMR136	116,40	2ASMR2136	179,63

Ensaio de Névoa Salina Salt Spray test Test brouillard salin	W1	W2
	72H	72H

W1 Totalmente Zincado/ Fully Zinc Plated Steel / Entièrement en Acier Zingué / Acero Cincado

W2 Chapa Inox AISI 304, Taco e Parafuso Zincado / Band in Stainless Steel AISI 304 With Zinc Plated Bolt and Screw

ABRAÇADEIRA SUPER MONTAGEM RÁPIDA

SUPER CLAMP QUICK MOUNTING

COLLIER TOURILLON DÉBRAYABLE

ABRAZADERA SUPER MONTAGE RÁPIDO



Und Cx	Medida Size Measure	Banda Band Bande	Parafuso Screw Vis	W1		W2	
				Code / Price / Prix		Code / Price / Prix	
				Código	€/100PCS	Código	€/100PCS
100	32-35	20x1	M6x50	2ASR1032	62,59	2ASR032	87,58
90	36-39	20x1	M6x50	2ASR1036	63,19	2ASR036	90,46
75	40-43	20x1	M6x50	2ASR1040	63,33	2ASR040	93,41
75	44-47	20x1	M6x50	2ASR1044	63,49	2ASR044	95,52
70	48-51	20x1	M6x50	2ASR1048	63,77	2ASR048	98,08
60	52-55	20x1	M6x50	2ASR1052	64,36	2ASR052	100,58
50	56-59	20x1	M6x55	2ASR1056	65,18	2ASR056	103,34
40	60-63	20x1	M6x55	2ASR1060	66,06	2ASR060	105,69
60	64-67	25x1,5	M8x70	2ASR1064	102,84	2ASR064	180,91
52	68-73	25x1,5	M8x70	2ASR1068	105,17	2ASR068	184,98
48	74-79	25x1,5	M8x70	2ASR1074	105,82	2ASR074	188,28
44	80-85	25x1,5	M8x70	2ASR1080	108,00	2ASR080	194,70
36	86-91	25x1,5	M8x70	2ASR1086	109,76	2ASR086	199,19
32	92-97	25x1,5	M8x70	2ASR1092	112,15	2ASR092	204,38
24	98-103	25x1,5	M8x70	2ASR1098	114,58	2ASR098	211,38
24	104-112	25x1,5	M8x80	2ASR1104	119,64	2ASR104	219,24
20	113-121	25x1,5	M8x80	2ASR1113	122,79	2ASR113	227,18
16	122-130	25x1,5	M8x80	2ASR1122	139,86	2ASR122	236,56
16	131-139	25x1,5	M8x80	2ASR1131	144,53	2ASR131	246,04
12	140-148	25x1,5	M8x80	2ASR1140	147,26	2ASR140	252,82
8	149-161	25x1,5	M8x90	2ASR1149	166,84	2ASR149	294,31
8	162-174	25x1,5	M8x90	2ASR1162	177,90	2ASR162	313,34
8	175-187	25x1,5	M8x90	2ASR1175	183,59	2ASR175	325,25
8	188-200	25x1,5	M8x90	2ASR1188	188,57	2ASR188	337,03
8	201-213	25x1,5	M8x90	2ASR1201	194,85	2ASR201	350,93
5	214-226	25x1,5	M8x90	2ASR1214	200,46	2ASR214	363,44
5	227-239	25x1,5	M8x90	2ASR1227	216,22	2ASR227	387,53

Ensaio de Névoa Salina

Salt Spray test

Test brouillard salin

W1

72H

W2

72H

W1

Totalmente Zincado/ Fully Zinc Plated Steel / Entièrement en Acier Zingué / Acero Cincado

W2

Chapa Inox AISI 304, Taco e Parafuso Zincado / Band in Stainless Steel AISI 304 With Zinc Plated Bolt and Screw

ABRAÇADEIRA SUPER DUPLA**SUPER DOUBLE CLAMP****COLLIER TOURILLON DOUBLE****ABRAZADERA SUPER DUPLA****Banda 20mm Parafuso M6 / Band 20mm Screw M6**

Und Cx	Medida Size Measure	W1		W5	
		Code / Price / Prix		Code / Price / Prix	
		Código	€/100PCS	Código	€/100PCS
10	40-48	2ASD20040	124,27	2ASD20040I	354,22
10	48-56	2ASD20048	125,34	2ASD20048I	361,69
10	56-64	2ASD20056	127,42	2ASD20056I	370,71
10	64-72	2ASD20064	131,32	2ASD20064I	384,00
10	72-80	2ASD20072	133,48	2ASD20072I	391,49
10	80-88	2ASD20080	135,62	2ASD20080I	398,50
10	88-96	2ASD20088	143,69	2ASD20088I	414,77
5	96-104	2ASD20096	146,05	2ASD20096I	422,68
5	104-112	2ASD20104	148,88	2ASD20104I	430,83
5	112-120	2ASD20112	150,50	2ASD20112I	437,80
5	120-128	2ASD20120	152,21	2ASD20120I	445,29
5	128-136	2ASD20128	153,90	2ASD20128I	452,78
5	136-146	2ASD20136	155,54	2ASD20136I	459,75
5	146-156	2ASD20146	157,45	2ASD20146I	468,79
5	156-166	2ASD20156	159,29	2ASD20156I	477,32
5	166-176	2ASD20166	161,25	2ASD20166I	486,62
5	176-186	2ASD20176	163,17	2ASD20176I	495,66
5	186-196	2ASD20186	165,05	2ASD20186I	504,45
5	196-206	2ASD20196	166,97	2ASD20196I	513,49
5	206-216	2ASD20206	168,85	2ASD20206I	522,28
5	216-226	2ASD20216	170,77	2ASD20216I	531,32

Ensaio de Névoa Salina
Salt Spray test
Test brouillard salin

W1

72H

W5

400H

W1

Totalmente Zincado/ Fully Zinc Plated Steel / Entièrement en Acier Zingué / Acero Cincado

W5

Chapa, Taco e Parafuso Inox AISI 316, Fully Stainless Steel AISI 316, Entièrement en Acier Inox AISI 316

ABRAÇADEIRA SUPER DUPLA

SUPER DOUBLE CLAMP

COLLIER TOURILLON DOUBLE

ABRAZADERA SUPER DUPLA



Banda 25mm Parafuso M8 / Band 25mm Screw M8

Und Cx	Medida Size Measure	W1		W5	
		Code / Price / Prix		Code / Price / Prix	
		Código	€/100PCS	Código	€/100PCS
10	80-95	2ASD25080	187,59	2ASD25080I	612,80
10	95-110	2ASD25095	194,89	2ASD25095I	633,13
10	110-125	2ASD25110	206,70	2ASD25110I	657,20
10	125-140	2ASD25125	214,69	2ASD25125I	678,85
5	140-155	2ASD25140	219,38	2ASD25140I	696,60
5	155-170	2ASD25155	260,79	2ASD25155I	803,60
5	170-185	2ASD25170	268,24	2ASD25170I	827,44
5	185-205	2ASD25185	274,34	2ASD25185I	850,03
5	205-225	2ASD25205	286,95	2ASD25205I	884,36
5	225-245	2ASD25225	313,20	2ASD25225I	931,16
5	245-265	2ASD25245	327,57	2ASD25245I	966,74
5	265-285	2ASD25265	340,20	2ASD25265I	1001,11
5	285-305	2ASD25285	353,30	2ASD25285I	1035,89
5	305-325	2ASD25305	354,84	2ASD25305I	1054,80
5	325-345	2ASD25325	358,86	2ASD25325I	1086,23
5	345-365	2ASD25345	366,15	2ASD25345I	1116,08
5	365-385	2ASD25365	372,80	2ASD25365I	1144,61
5	385-405	2ASD25385	381,04	2ASD25385I	1174,95
5	405-425	2ASD25405	391,41	2ASD25405I	1207,25
5	425-445	2ASD25425	399,88	2ASD25425I	1237,44
5	445-465	2ASD25445	413,52	2ASD25445I	1273,09

Ensaio de Nêvoa Salina
Salt Spray test
Test brouillard salin

W1

72H

W5

400H

W1

Totalmente Zincado/ Fully Zinc Plated Steel / Entièrement en Acier Zingué / Acero Cincado

W5

Chapa, Taco e Parafuso Inox AISI 316, Fully Stainless Steel AISI 316, Entièrement en Acier Inox AISI 316

ABRAÇADEIRA SUPER DUPLA**SUPER DOUBLE CLAMP****COLLIER TOURILLON DOUBLE****ABRAZADERA SUPER DUPLA****Banda 30mm Parafuso M10 / Band 30mm Screw M10**

Und Cx	Medida Size Measure	W1		W5	
		Code / Price / Prix		Code / Price / Prix	
		Código	€/100PCS	Código	€/100PCS
10	80-95	2ASD30080	311,24	2ASD30080I	1126,82
10	95-110	2ASD30095	321,86	2ASD30095I	1165,34
10	110-125	2ASD30110	334,19	2ASD30110I	1222,61
10	125-140	2ASD30125	352,33	2ASD30125I	1267,86
5	140-155	2ASD30140	383,20	2ASD30140I	1358,25
5	155-170	2ASD30155	405,73	2ASD30155I	1403,23
5	170-185	2ASD30170	415,68	2ASD30170I	1437,01
5	185-205	2ASD30185	425,16	2ASD30185I	1470,34
5	205-225	2ASD30205	441,84	2ASD30205I	1518,59
5	225-245	2ASD30225	462,85	2ASD30225I	1570,66
5	245-265	2ASD30245	481,09	2ASD30245I	1683,12
5	265-285	2ASD30265	489,48	2ASD30265I	1723,45
5	285-305	2ASD30285	498,96	2ASD30285I	1765,26
5	305-325	2ASD30305	507,47	2ASD30305I	1806,23
5	325-345	2ASD30325	521,74	2ASD30325I	1852,31
5	345-365	2ASD30345	535,06	2ASD30345I	1897,56
5	365-385	2ASD30365	551,02	2ASD30365I	1945,14
5	385-405	2ASD30385	562,06	2ASD30385I	1987,84
5	405-425	2ASD30405	572,26	2ASD30405I	2030,29
5	425-445	2ASD30425	581,96	2ASD30425I	2072,32
5	445-465	2ASD30445	590,00	2ASD30445I	2112,87

Ensaio de Névoa Salina
Salt Spray test
Test brouillard salin

W1

72H

W5

400H

W1

Totalmente Zincado/ Fully Zinc Plated Steel / Entièrement en Acier Zingué / Acero Cincado

W5

Chapa, Taco e Parafuso Inox AISI 316, Fully Stainless Steel AISI 316, Entièrement en Acier Inox AISI 316

ABRAZADERA SUPER N DIN 3017



Recommendation resistance - 8Nm

Und Cx	Medida	W1		W2		W4		W5	
	Size	Code / Price / Prix		Code / Price / Prix		Code / Price / Prix		Code / Price / Prix	
	Mesure	Código	€/100PCS	Código	€/100PCS	Código	€/100PCS	Código	€/100PCS
50	17-19	2GBS18017	40,08	2GBS18017I2	52,07	2GBS18017I4	83,60	2GBS18017I	91,47
50	19-21	2GBS18019	40,31	2GBS18019I2	52,80	2GBS18019I4	84,19	2GBS18019I	92,23
50	21-23	2GBS18021	40,53	2GBS18021I2	53,47	2GBS18021I4	84,71	2GBS18021I	92,89
50	23-25	2GBS18023	40,74	2GBS18023I2	54,13	2GBS18023I4	85,28	2GBS18023I	93,65
50	25-27	2GBS18025	41,62	2GBS18025I2	54,91	2GBS18025I4	86,69	2GBS18025I	94,53
50	27-29	2GBS18027	41,82	2GBS18027I2	55,58	2GBS18027I4	87,27	2GBS18027I	95,19
50	29-31	2GBS18029	42,09	2GBS18029I2	56,45	2GBS18029I4	88,11	2GBS18029I	96,14
50	31-34	2GBS18031	42,47	2GBS18031I2	57,45	2GBS18031I4	90,14	2GBS18031I	98,47
50	34-37	2GBS18034	42,70	2GBS18034I2	58,18	2GBS18034I4	90,73	2GBS18034I	99,23
50	37-40	2GBS18037	43,06	2GBS18037I2	59,35	2GBS18037I4	91,79	2GBS18037I	100,46
50	40-43	2GBS18040	44,80	2GBS18040I2	61,65	2GBS18040I4	93,85	2GBS18040I	102,76
50	43-47	2GBS18043	45,25	2GBS18043I2	62,76	2GBS18043I4	95,27	2GBS18043I	104,73
50	47-51	2GBS18047	45,64	2GBS18047I2	63,95	2GBS18047I4	96,28	2GBS18047I	105,99
50	51-55	2GBS18051	46,06	2GBS18051I2	65,18	2GBS18051I4	97,30	2GBS18051I	107,26
50	55-59	2GBS18055	46,56	2GBS18055I2	66,48	2GBS18055I4	99,06	2GBS18055I	113,20
50	59-63	2GBS18059	46,99	2GBS18059I2	67,74	2GBS18059I4	100,08	2GBS18059I	114,46
50	63-68	2GBS18063	47,33	2GBS18063I2	68,78	2GBS18063I4	101,07	2GBS18063I	115,73
50	68-73	2GBS18068	47,85	2GBS18068I2	70,37	2GBS18068I4	102,29	2GBS18068I	117,28
50	73-79	2GBS18073	48,37	2GBS18073I2	72,05	2GBS18073I4	103,44	2GBS18073I	118,73

Recommendation resistance - 10Nm

Und Cx	Medida	W1		W2		W4		W5	
	Size	Code / Price / Prix		Code / Price / Prix		Code / Price / Prix		Code / Price / Prix	
	Mesure	Código	€/100PCS	Código	€/100PCS	Código	€/100PCS	Código	€/100PCS
50	31-34			2GBS20031I2	74,36				
50	34-37			2GBS20034I2	75,09				
50	37-40			2GBS20037I2	75,83				
50	40-43			2GBS20040I2	76,62				
50	43-47	2GBS20043	54,94	2GBS20043I2	77,41	2GBS20043I4	125,59		
50	47-51	2GBS20047	55,59	2GBS20047I2	79,44	2GBS20047I4	127,40		
50	51-55	2GBS20051	56,20	2GBS20051I2	81,29	2GBS20051I4	129,09		
50	55-59	2GBS20055	57,24	2GBS20055I2	83,53	2GBS20055I4	135,64		
50	59-63	2GBS20059	57,96	2GBS20059I2	85,42	2GBS20059I4	137,38		
50	63-68	2GBS20063	58,75	2GBS20063I2	87,61	2GBS20063I4	139,35		
25	68-73	2GBS20068	59,50	2GBS20068I2	89,65	2GBS20068I4	141,08		
25	73-79	2GBS20073	60,29	2GBS20073I2	91,77	2GBS20073I4	142,75		
25	79-85	2GBS20079	61,15	2GBS20079I2	94,16	2GBS20079I4	144,70		
25	85-91	2GBS20085	62,12	2GBS20085I2	97,01	2GBS20085I4	147,14		
Ensaio de Névoa Salina Salt Spray test Test brouillard salin		W1		W2		W4		W5	
		72H		72H		240H		400H	

W1	Totalmente Zincado/ Fully Zinc Plated Steel / Entièrement en Acier Zingué / Acero Cincado
W2	Chapa Inox AISI 304, Taco e Parafuso Zincado / Band in Stainless Steel AISI 304 With Zinc Plated Bolt and Screw
W4	Chapa e Pf Inox AISI 304, Taco Latão Niquelado / Band and Screw in Stainless Steel AISI 304 With Nickel Plated Brass Bolt
W5	Chapa e Pf Inox AISI 316, Taco Latão Niquelado / Band and Screw in Stainless Steel AISI 316 With Nickel Plated Brass Bolt

ABRAÇADEIRA SUPER N DIN 3017

SUPER N CLAMP DIN 3017

COLLIER TOURILLON N DIN 3017

ABRAZADERA SUPER N DIN 3017

**Banda 25mm Parafuso M8 / Band 25mm Screw M8**

Recommendation resistance - 20Nm

Und Cx	Medida Size Measure	W1		W2		W4		W5	
		Code / Price / Prix		Code / Price / Prix		Code / Price / Prix		Code / Price / Prix	
		Código	€/100PCS	Código	€/100PCS	Código	€/100PCS	Código	€/100PCS
25	68-73	2GBS25068	75,67	2GBS25068I2	118,91	2GBS25068I4	205,71	2GBS25068I	251,71
25	73-79	2GBS25073	76,62	2GBS25073I2	121,46	2GBS25073I4	208,24	2GBS25073I	254,96
25	79-85	2GBS25079	77,97	2GBS25079I2	125,46	2GBS25079I4	212,46	2GBS25079I	260,13
25	85-91	2GBS25085	79,53	2GBS25085I2	128,87	2GBS25085I4	215,83	2GBS25085I	264,35
25	91-97	2GBS25091	81,11	2GBS25091I2	132,39	2GBS25091I4	219,33	2GBS25091I	268,75
25	97-104	2GBS25097	82,65	2GBS25097I2	136,41	2GBS25097I4	223,57	2GBS25097I	273,86
25	104-112	2GBS25104	86,91	2GBS25104I2	142,96	2GBS25104I4	233,53	2GBS25104I	290,84
25	112-121	2GBS25112	88,00	2GBS25112I2	146,64	2GBS25112I4	237,16	2GBS25112I	295,67
25	121-130	2GBS25121	90,64	2GBS25121I2	152,71	2GBS25121I4	243,46	2GBS25121I	303,26
10	130-140	2GBS25130	94,43	2GBS25130I2	159,53	2GBS25130I4	250,22	2GBS25130I	311,41
10	140-150	2GBS25140	96,10	2GBS25140I2	164,91	2GBS25140I4	255,52	2GBS25140I	318,45
10	150-162	2GBS25150	101,86	2GBS25150I2	173,42	2GBS25150I4	271,04	2GBS25150I	329,07
10	162-174	2GBS25162	109,95	2GBS25162I2	185,25	2GBS25162I4	282,75	2GBS25162I	342,53
10	174-187	2GBS25174	111,64	2GBS25174I2	190,87	2GBS25174I4	288,31	2GBS25174I	349,91

Banda 30mm Parafuso M10 / Band 30mm Screw M10

Recommendation resistance - 25Nm

Und Cx	Medida Size Measure	W1		W2		W4		W5	
		Code / Price / Prix		Code / Price / Prix		Code / Price / Prix		Code / Price / Prix	
		Código	€/100PCS	Código	€/100PCS	Código	€/100PCS	Código	€/100PCS
10	130-140	2GBS30130	135,96	2GBS30130I2	242,38	2GBS30130I4	335,10		
10	140-150	2GBS30140	138,22	2GBS30140I2	249,64	2GBS30140I4	340,79		
10	150-162	2GBS30150	145,51	2GBS30150I2	262,30	2GBS30150I4	350,47		
10	162-174	2GBS30162	161,36	2GBS30162I2	282,36	2GBS30162I4	377,10		
10	174-187	2GBS30174	164,30	2GBS30174I2	291,30	2GBS30174I4	384,12		
10	187-200	2GBS30187	167,64	2GBS30187I2	301,04	2GBS30187I4	391,82		
10	200-213	2GBS30200	170,89	2GBS30200I2	310,81	2GBS30200I4	399,52		
10	213-226	2GBS30213	174,16	2GBS30213I2	320,34	2GBS30213I4	407,04		
10	226-239	2GBS30226	182,77	2GBS30226I2	335,59	2GBS30226I4	419,91		
10	239-252	2GBS30239	189,86	2GBS30239I2	349,74	2GBS30239I4	439,06		
10	252-265	2GBS30252	193,34	2GBS30252I2	359,70	2GBS30252I4	446,94		
10	265-278	2GBS30265	196,47	2GBS30265I2	369,28	2GBS30265I4	454,46		
10	278-291	2GBS30278	199,66	2GBS30278I2	378,76	2GBS30278I4	461,93		
10	291-304	2GBS30291	202,77	2GBS30291I2	388,32	2GBS30291I4	469,45		
10	304-317	2GBS30304	208,31	2GBS30304I2	400,41	2GBS30304I4	479,34		
10	317-330	2GBS30317	211,20	2GBS30317I2	409,73	2GBS30317I4	486,64		

Ensaio de Nêvoa Salina Salt Spray test Test brouillard salin	W1	W2	W4	W5
	72H	72H	240H	400H

W1	Totalmente Zincado/ Fully Zinc Plated Steel / Entièrement en Acier Zingué / Acero Cincado
W2	Chapa Inox AISI 304, Taco e Parafuso Zincado / Band in Stainless Steel AISI 304 With Zinc Plated Bolt and Screw
W4	Chapa e Pf Inox AISI 304, Taco Latão Niquelado / Band and Screw in Stainless Steel AISI 304 With Nickel Plated Brass Bolt
W5	Chapa e Pf Inox AISI 316, Taco Latão Niquelado / Band and Screw in Stainless Steel AISI 316 With Nickel Plated Brass Bolt

ABRAÇADEIRA SUPER DUPLA N**SUPER DOUBLE N CLAMP****COLLIER TOURILLON DOUBLE N****ABRAZADERA SUPER DUPLA N****Banda 18mm Parafuso M6 / Band 18mm Screw M6**

Und Cx	Medida	W1		W4	
	Size	Code / Price / Prix		Code / Price / Prix	
	Mesure	Código	€/100PCS	Código	€/100PCS
10	59-67	2AD18059	79,43	2AD18059I4	171,84
10	67-75	2AD18067	80,73	2AD18067I4	175,59

Banda 20mm Parafuso M7 / Band 20mm Screw M7

Und Cx	Medida	W1		W4	
	Size	Code / Price / Prix		Code / Price / Prix	
	Mesure	Código	€/100PCS	Código	€/100PCS
10	67-75	2AD20067	101,12	2AD20067I4	232,42
10	75-83	2AD20075	102,59	2AD20075I4	235,36
10	83-91	2AD20083	104,09	2AD20083I4	238,27
10	88-100	2AD20088	105,29	2AD20088I4	241,50

Banda 25mm Parafuso M8 / Band 25mm Screw M8

Und Cx	Medida	W1		W4	
	Size	Code / Price / Prix		Code / Price / Prix	
	Mesure	Código	€/100PCS	Código	€/100PCS
10	88-100	2AD25088	138,32	2AD25088I4	367,82
10	100-116	2AD25100	142,40	2AD25100I4	376,13
10	116-136	2AD25116	147,43	2AD25116I4	390,83
10	136-156	2AD25136	156,70	2AD25136I4	407,92
10	156-180	2AD25156	166,28	2AD25156I4	430,45

Banda 30mm Parafuso M10 / Band 30mm Screw M10

Und Cx	Medida	W1		W4	
	Size	Code / Price / Prix		Code / Price / Prix	
	Mesure	Código	€/100PCS	Código	€/100PCS
10	125-145	2AD30125	228,82	2AD30125I4	542,59
10	145-168	2AD30145	233,33	2AD30145I4	555,39
10	168-193	2AD30168	251,16	2AD30168I4	586,94
10	193-220	2AD30193	267,73	2AD30193I4	613,02
10	220-245	2AD30220	273,70	2AD30220I4	631,26
10	245-270	2AD30245	283,09	2AD30245I4	663,33
10	270-295	2AD30270	288,95	2AD30270I4	678,95
10	295-320	2AD30295	295,14	2AD30295I4	693,43
10	320-345	2AD30320	309,44	2AD30320I4	716,42

Ensaio de Nêvoa Salina Salt Spray test Test brouillard salin	W1	W4
	72H	240H

W1 Totalmente Zincado/ Fully Zinc Plated Steel / Entièrement en Acier Zingué / Acero Cincado**W4** Chapa e Pf Inox AISI 304, Taco Latão Niquelado / Band and Screw in Stainless Steel AISI 304 With Nickel Plated Brass Bolt

ABRAÇADEIRA PERFIL

PROFILE CLAMP

COLLIER PROFIL

ABRAZADERA PERFIL



Units/ Box	Medida Size Mesure	W1		W4	
		Code / Price / Prix		Code / Price / Prix	
		Código	€/100PCS	Código	€/100PCS
50	110			2API110	48,37
50	125			2API125	51,85
50	130			2API130	53,28
50	150			2API150	57,80
50	180			2API180	64,40
50	200			2API200	68,92

ABRAÇADEIRA TIPO ITALIANO

ITALIAN TYPE CLAMP

COLLIER TYPE ITALIEN

ABRAZADERA TIPO ITALIANA

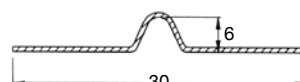

1 Abraçadeira leva 2 parafusos DIN 933 M8x30 e 2 porcas DIN 934

Units/ Box	Size / Maß Medida / Mesure	W1		W4	
		Code / Price / Prix		Code / Price / Prix	
		Código	€/100PCS	Código	€/100PCS
50	80	2ATI80	56,36		
50	100	2ATI100	60,51		
50	120	2ATI120	65,94		
50	130	2ATI130	71,13		
50	140	2ATI140	71,60		
50	150	2ATI150	75,49		
50	180	2ATI180	122,29		
50	200	2ATI200	130,47		
50	220	2ATI220	138,82		
50	250	2ATI250	150,77		
50	280	2ATI280	162,98		
50	300	2ATI300	171,42		
50	315	2ATI315	180,05		
50	350	2ATI350	194,35		
50	380	2ATI380	207,84		
50	400	2ATI400	218,22		

W1

Totalmente Zincado/ Fully Zinc plated steel / Entièrement en acier Zingué / Acero cincado

W4

Totalmente em Inox AISI 304 / Fully Stainless AISI 304 / Entièrement en Acier Inox AISI 304 / Acero Inoxidable AISI 304

ABRAÇADEIRA TIPO "E"

CLAMP TYPE "E"

COLLIER TYPE "E"

ABRAZADERA TIPO "E"

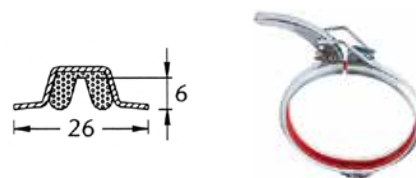

Units/Box	Size / Maß Medida / Measure	W1		W4	
		Code / Price / Prix		Code / Price / Prix	
		Código	€/100PCS	Código	€/100PCS
40	80	2TE080	316,75		
24	100	2TE100	336,25	2TEI100	697,74
16	120	2TE120	365,48	2TEI120	708,82
16	125	2TE125	370,36	2TEI125	708,82
16	130	2TE130	375,23		
16	140	2TE140	389,85		
16	150	2TE150	414,22	2TEI150	719,89
16	160	2TE160	426,40		
8	180	2TE180	438,58		
8	200	2TE200	453,20	2TEI200	764,19
8	220	2TE220	487,31	2TEI220	775,27
8	225	2TE225	499,49		
42	250	2TE250	509,24	2TEI250	819,57
40	275	2TE275	543,35		
40	280	2TE280	548,23		
30	300	2TE300	562,85	2TEI300	864,98
30	315	2TE315	584,77		
30	350	2TE350	621,32	2TEI350	941,40
35	355	2TE355	633,51	2TEI355	941,40
35	375	2TE375	657,87	2TEI375	946,94
35	400	2TE400	682,24	2TEI400	952,47
30	425	2TE425	706,60	2TEI425	985,70
30	450	2TE450	730,97		
30	500	2TE500	755,33		
30	550	2TE550	779,70		
25	600	2TE600	840,61		

ABRAÇADEIRA TIPO "D"

CLAMP TYPE "D"

COLLIER TYPE "D"

ABRAZADERA TIPO "D"

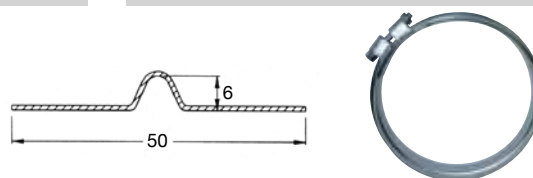

Units/Box	Size / Maß Medida / Measure	W1		W4	
		Code / Price / Prix		Code / Price / Prix	
		Código	€/100PCS	Código	€/100PCS
108	160	2D160	143,45		
108	180	2D180	148,90		
72	200	2D200	154,65		
60	225	2D225	162,64		
48	250	2D250	171,15		
48	275	2D275	178,08		
30	300	2D300	189,77		
20	315	2D315	194,00		
26	350	2D350	205,56		
40	400	2D400	214,04		
40	450	2D450	395,16		
40	500	2D500	508,06		
40	550	2D550	884,66		
25	600	2D600	931,89		
	630	2D630	937,39		
	650	2D650	956,26		
	700	2D700	1001,59		
	750	2D750	1047,97		
	800	2D800	1094,06		
	900	2D900	1149,35		
	950	2D950	1205,81		

W1

Totalmente Zincado/ Fully Zinc plated steel / Entièrement en acier Zingué / Acero cincado

Fixing Clamp

Abraçadeira de Fixação



ABRAÇADEIRA LIFTUBE SIMPLES

SIMPLE CLAMP LIFTUBE

COLLIER SIMPLE LIFTUBE

ABRAZADERA SIMPLE LIFTUBE



Units/Box	Und Caixote	Size / Maß Medida / Measure	W4			
			Code / Price / Prix		Liftube	
			Código	€/100PCS	Código	€/100PCS
150						
90	1620 (18cx)	15			2AFS15	28,00
60	1080 (18cx)	18			2AFS18	30,15
40	720 (18cx)	22			2AFS22	44,94
20	600 (30cx)	28			2AFS28	60,40

ABRAÇADEIRA LIFTUBE DUPLA

DOUBLE CLAMP LIFTUBE

COLLIER DOUBLE LIFTUBE

ABRAZADERA DOBLE LIFTUBE



Units/Box	Und Caixote	Size / Maß Medida / Measure	W4			
			Code / Price / Prix		Liftube	
			Código	€/100PCS	Código	€/100PCS
30	900 (30cx)	15			2AFD15	103,87
25	750 (30cx)	18			2AFD18	117,42
15	450 (30cx)	22			2AFD22	146,77

ABRAÇADEIRA LIFTUBE MÉTRICA FÊMEA/MACHO

CLAMP LIFTUBE METRIC FEMALE / MALE

COLLIER LIFTUBE MÉTRIQUE FEMELLE / MALE

ABRAZADERA LIFTUBE MÉTRICO HEMBRA / MALE



Fêmea/Female/Femelle/Hembra

Macho/Male/Mâle

Units/Box	Und Caixote	Size / Maß Medida / Measure	W4			
			Liftube - Métrica Fêmea		Liftube - Métrica Macho	
			Código	€/100PCS	Código	€/100PCS
90	1620 (18cx)	15	2AFF15	42,18	2AFM15	42,18
60	1080 (18cx)	18	2AFF18	45,33	2AFM18	45,33
40	720 (18cx)	22	2AFF22	61,15	2AFM22	61,15
20	600 (30cx)	28	2AFF28	76,13	2AFM28	76,13

ABRAÇADEIRA COM PORCA M8**CLAMP WITH NUT M8****COLLIER AVEC ÉCROU M8****ABRAZADERA CON TUERCA M8**

Units/ Box	"	Ø (mm)	Banda Band Bande	W1				W4			
				Sem Borracha Without Rubber		Com Borracha With Rubber		Sem Borracha Without Rubber		Com Borracha With Rubber	
				Code / Price / Prix Código €/100PCS		Code / Price / Prix Código €/100PCS		Code / Price / Prix Código €/100PCS		Code / Price / Prix Código €/100PCS	
50	1/2	20	16x1,5	2AEP050	18,83	2AEPB8050	25,54	2AEPi050	60,63	2AEPBi8050	69,18
50	3/4	25	16x1,5	2AEP075	19,31	2AEPB8075	26,91	2AEPi075	62,89	2AEPBi8075	71,66
50	1"	32	16x1,5	2AEP100	20,69	2AEPB8100	29,50	2AEPi100	68,98	2AEPBi8100	78,37
50	1 1/4	40	16x1,5	2AEP125	22,16	2AEPB8125	32,33	2AEPi125	75,87	2AEPBi8125	85,94
50	1 1/2	50	16x1,5	2AEP150	23,88	2AEPB8150	35,75	2AEPi150	83,89	2AEPBi8150	94,76
50	2"	63	16x1,5	2AEP200	29,19	2AEPB8200	42,91	2AEPi200	97,32	2AEPBi8200	109,54
50	2 1/2	75	16x1,8	2AEP250	38,33	2AEPB8250	53,38	2AEPi250	110,98	2AEPBi8250	124,57
50	2 3/4	80	16x1,8	2AEP275	41,72	2AEPB8275	57,29	2AEPi275	118,77	2AEPBi8275	134,38
50	3"	90	16x1,8	2AEP300	43,52	2AEPB8300	61,08	2AEPi300	124,76	2AEPBi8300	140,96
50	3 1/2	100	16x1,8	2AEP350	48,10	2AEPB8350	67,21	2AEPi350	131,18	2AEPBi8350	148,02
50	4"	110	16x1,8	2AEP400	50,02	2AEPB8400	71,38	2AEPi400	134,72	2AEPBi8400	151,91
25	4 1/2	115	16x1,8	2AEP450	52,22	2AEPB8450	74,31	2AEPi450	138,90	2AEPBi8450	156,51
25		120	16x1,8	2AEP480	53,06	2AEPB8480	76,16	2AEPi480	140,00	2AEPBi8480	157,73
25	5"	125	16x1,8	2AEP500	53,80	2AEPB8500	78,00	2AEPi500	142,98	2AEPBi8500	161,00
25	6"	140	16x1,8	2AEP600	57,33	2AEPB8600	84,20	2AEPi600	154,88	2AEPBi8600	174,09

ABRAÇADEIRA MARCA INTERIOR**CLAMP INSIDE MARK****COLLIER MARQUE INTÉRIEUR****ABRAZADERA MARCA INTERIOR**

Units/ Box	"	Ø (mm)	Aperto Range Serrage	Banda Band Bande	Porca / Parafuso Nut / Screw Écrou / Vis	W4		W5	
						Code / Price / Prix		Code / Price / Prix	
						Código	€/100PCS	Código	€/100PCS
100	1/8	10	8-11	16x1,5	M6 / M6x10	2APMI4010	41,56	2APMI010	46,76
100	1/4	12	10-13	16x1,5	M6 / M6x10	2APMI4012	42,30	2APMI012	47,75
100	3/8	15	14-17	16x1,5	M6 / M6x10	2APMI4015	43,06	2APMI015	48,72
100		18	17-20	16x1,5	M6 / M6x10	2APMI4018	43,82	2APMI018	49,74
100	1/2	20	19-22	16x1,5	M6 / M6x10	2APMI4020	44,88	2APMI020	51,17
100		22	21-24	16x1,5	M6 / M6x12	2APMI4022	45,26	2APMI022	51,81
100	3/4	25	23-27	16x1,5	M6 / M6x12	2APMI4025	46,76	2APMI025	53,80
100		28	25-29	16x1,5	M6 / M6x12	2APMI4028	47,80	2APMI028	55,08
100	1"	32	29-33	16x1,5	M6 / M6x12	2APMI4032	49,91	2APMI032	57,83
100		35	34-38	16x1,5	M6 / M6x12	2APMI4035	51,66	2APMI035	60,06
100	1 1/4	40	38-42	16x1,5	M8 / M6x12	2APMI4040	59,65	2APMI040	68,66
100		42	40-44	16x1,5	M8 / M6x12	2APMI4042	61,65	2APMI042	71,13
100	1 1/2	50	48-52	16x1,5	M8 / M6x12	2APMI4050	65,13	2APMI050	75,75
100		54	53-57	16x1,5	M8 / M6x16	2APMI4054	69,30	2APMI054	80,92
100	2"	63	61-65	16x1,5	M8 / M6x16	2APMI4063	73,71	2APMI063	86,33
100	2 1/2	75	73-77	16x1,5	M8 / M6x16	2APMI4075	79,40	2APMI075	93,87
100	3"	90	88-92	16x1,5	M8 / M6x16	2APMI4090	84,19	2APMI090	99,75
100	3 1/2	110	108-112	16x1,5	M8 / M6x16	2APMI4110	95,86	2APMI110	115,25
100	5"	125	123-127	16x1,5	M8 / M6x16	2APMI4125	105,03	2APMI125	127,27

PARAFUSO PARA ABRAÇADEIRA**SCREW CLAMPS****VIS POUR COLLIER****TORNILLO PARA ABRAZADERA**

Size / Maß	A2	
Medida / Measure	Code / Price / Prix	
	Código	€/100PCS
M6x30	2PPAI630	11,01
M6x40	2PPAI640	11,45

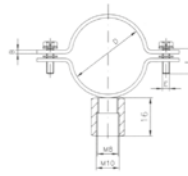
ABRAÇADEIRA REFORÇADA M8 / M8+M10**REINFORCED PIPE CLAMP M8 / M8+M10****COLLIER RENFORCÉ M8 / M8+M10****ABRAZADERA REFORZADA M8 / M8+M10**

Units/ Box	Size / Maß/Medida / Mesure			Banda	Parafuso	W1			
	"	Ø (mm)	Aperto	Band	Screw	M8		M8+M10	
			Range			Code / Price / Prix		Code / Price / Prix	
			Serrage	Bande	Vis	Código	€/100PCS	Código	€/100PCS
50	3/8	18	17-20	20x2	M6x16	2APRS017	27,94	2APR017	32,23
50	1/2	22	20-25	20x2	M6x16	2APRS020	30,71	2APR020	35,00
50	3/4	28	26-32	20x2	M6x16	2APRS026	32,27	2APR026	36,56
50	1"	35	33-38	20x2	M6x16	2APRS032	33,83	2APR032	38,12
50	1 1/4	40	38-43	20x2	M6x16	2APRS038	37,29	2APR038	41,58
50	1 1/2	48	48-53	20x2	M6x20	2APRS047	40,76	2APR047	45,05
50		54	52-57	20x2	M6x20	2APRS053	44,74	2APR053	49,03
50	2"	60	60-63	20x2	M6x20	2APRS060	46,13	2APR060	50,42
50		70	68-74	20x2	M6x20	2APRS068	48,55	2APR068	52,85
50	2 1/2	75	74-80	20x2	M6x20	2APRS074	49,77	2APR074	54,06
25		84	81-84	20x2	M6x20	2APRS081	51,33	2APR081	55,62
25	3"	90	87-93	20x2	M6x20	2APRS087	52,71	2APR087	57,00
25		100	96-100	20x2	M6x20	2APRS099	54,10	2APR099	58,39
25	4"	110	107-112	20x2	M6x25	2APRS107	55,49	2APR107	59,78
25	4"	115	109-115	20x2	M6x25	2APRS113	57,92	2APR113	62,21
25	5"	125	125-131	20x2	M6x25	2APRS125	60,06	2APR125	64,35
25	5"	140	138-144	20x2	M6x25	2APRS138	63,28	2APR138	67,57
25		150	149-160	20x2	M6x25	2APRS148	68,65	2APR148	72,94
25	6"	160	158-165	20x2	M6x25	2APRS159	81,52	2APR159	85,81
25		180	179-185	20x2	M6x25	2APRS179	90,10	2APR179	94,39
25		200	199-206	28x2	M6x25	2APRS200	98,68	2APR200	102,97
25		220	215-220	28x2	M6x30	2APRS215	121,74	2APR215	126,03
25		225	218-230	28x2	M6x30	2APRS223	133,85	2APR223	144,43
25		250	248-255	28x2	M6x30	2APRS249	142,48	2APR249	153,07
25		280	279-284	28x2	M6x30	2APRS279	154,71	2APR279	165,26
25		300	300-311	28x2	M6x30	2APRS299	163,29	2APR299	173,87
25		315	314-319	28x2	M6x30	2APRS314	170,68	2APR314	181,24
25		350	348-355	28x2	M6x30	2APRS354	182,25	2APR354	192,84
25		400	398-410	28x2	M6x30	2APRS400	213,79	2APR400	218,08
25		450	447-458	28x2	M6x30	2APRS450	263,75	2APR450	268,04
25		500	499-506	28x2	M6x30	2APRS500	300,91	2APR500	305,20
25		560	559-568	28x2,5	M6x30	2APRS550	339,50	2APR550	343,79
25		600	599-608	28x2,5	M6x30	2APRS560	361,97	2APR560	366,26
25		630	629-636	28x2,5	M6x30	2APRS630	375,24	2APR630	379,53
25		650	649-656	28x2,5	M6x30	2APRS650	393,60	2APR650	398,12
25		700	699-706	28x2,5	M6x30	2APRS700	412,41	2APR700	416,70
25		800	799-806	28x2,5	M6x30	2APRS800	466,47	2APR800	470,76
25		900	899-906	28x2,5	M6x30	2APRS900	601,61	2APR900	605,90
25		1000	999-1006	28x2,5	M6x30	2APRS1000	727,75	2APR1000	732,04
25		1100	1099-1106	28x2,5	M6x30	2APRS1100	937,22	2APR1100	941,51
25		1200	1199-1206	28x2,5	M6x30	2APRS1200	981,14	2APR1200	985,43
25		1250	1249-1256	28x2,5	M6x30	2APRS1250	997,23	2APR1250	1001,52

PARAFUSO PARA ABRAÇADEIRA**SCREW CLAMPS****VIS POUR COLLIER****TORNILLO PARA ABRAZADERA**

Size / Maß	W1	
	Code / Price / Prix	
Medida / Mesure	Código	€/100PCS
M8x40	2PPA840	3,78
M8x60	2PPA860	5,17
M8x80	2PPA880	7,68
M10x50	2PPA1050	7,81
M10x70	2PPA1070	12,90

ABRAÇADEIRA REFORÇADA M8 / M8+M10 COM BORRACHA DIN 4109**ISOPHONIC PIPE CLAMP M8 / M8+M10****COLLIER EN CAOUTCHOUC RENFORCÉ M8 / M8+M10 DIN 4109****ABRAZADERA REFORZADA M8 / M8+M10 CON GOMA DIN 4109**

Com porca extra (2 porcas) + 10€ líquido

Borracha Preta ou Amarela / Yellow or Black Rubber/ Caoutchouc Jaune ou Noir / Goma Amarillo o Negro

Units/ Box	Size / Maß/Medida /Measure			Banda	Parafuso	W1			
	"	Ø (mm)	Aperto	Band	Screw	M8		M8+M10	
			Range			Code / Price / Prix		Code / Price / Prix	
			Serrage			Código	€/100PCS	Código	€/100PCS
50	3/8	18	17-22	20x2	M6x16	2APSB017	27,48	2APB017	36,35
50	1/2	22	20-26	20x2	M6x16	2APSB020	28,43	2APB020	38,87
50	3/4	28	26-31	20x2	M6x16	2APSB026	31,10	2APB026	41,11
50	1"	35	32-36	20x2	M6x16	2APSB032	33,39	2APB032	44,46
25	1 1/4	40	38-44	20x2	M6x16	2APSB038	36,66	2APB038	48,66
25	1 1/2	48	48-52	20x2	M6x20	2APSB047	39,98	2APB047	53,41
25		54	53-59	20x2	M6x20	2APSB053	44,63	2APB053	56,77
25	2"	60	60-66	20x2	M6x20	2APSB060	49,77	2APB060	60,68
25		70	68-72	20x2	M6x20	2APSB068	53,35	2APB068	64,60
25	2 1/2	75	74-82	20x2	M6x20	2APSB074	53,35	2APB074	67,68
25		84	83-83	20x2	M6x20	2APSB081	60,22	2APB081	71,59
25	3"	90	87-92	20x2	M6x20	2APSB087	60,22	2APB087	77,25
25		100	99-103	20x2	M6x20	2APSB099	68,83	2APB099	88,93
25	4"	110	109-115	20x2	M6x25	2APSB107	74,73	2APB107	92,86
25	4"	115	113-119	20x2	M6x25	2APSB113	93,21	2APB113	97,50
25	5"	125	125-131	20x2	M6x25	2APSB125	107,81	2APB125	112,10
25		133	131-137	20x2	M6x25	2APSB131	118,90	2APB131	123,19
25	5"	140	138-142	20x2	M6x25	2APSB138	122,01	2APB138	126,31
25		150	149-155	20x2	M6x25	2APSB148	127,38	2APB148	131,67
25	6"	160	159-165	20x2	M6x25	2APSB159	135,88	2APB159	140,16
25		180	177-185	20x2	M6x25	2APSB179	150,74	2APB179	155,03
25		200	200-205	28x2	M6x30	2APSB200	173,04	2APB200	177,33
25		220	219-226	28x2	M6x30	2APSB215	250,41	2APB215	254,70
25		225	224-229	28x2	M6x30	2APSB223	280,90	2APB223	285,19
25		250	249-255	28x2	M6x30	2APSB249	315,38	2APB249	319,67
25		280	279-285	28x2	M6x30	2APSB279	333,22	2APB279	337,52
25		300	300-306	28x2	M6x30	2APSB299	339,64	2APB299	343,93
25		315	315-320	28x2	M6x30	2APSB314	365,11	2APB314	369,40
25		350	349-356	28x2	M6x30	2APSB354	441,52	2APB354	445,81
25		400	400-405	28x2	M6x30	2APSB400	452,34	2APB400	456,62
25		450	450-455	28x2	M6x30	2APSB450	500,27	2APB450	504,56
25		500	499-505	28x2	M6x30	2APSB500	541,27	2APB500	545,56
25		560		28x2,5	M6x30	2APSB560	666,25	2APB560	670,55
25		600	599-606	28x2,5	M6x30	2APSB600	713,31	2APB600	717,60
25		630	629-636	28x2,5	M6x30	2APSB630	746,95	2APB630	751,24
25		710	709-716	28x2,5	M6x30	2APSB700	826,34	2APB700	830,63

PERFIL DE BORRACHA**PROFILE RUBBER****PROFIL EN CAOUTCHOUC****PERFIL DE GOMA**

Equivalência Equivalence	Size / Maß Medida / Measure	Code / Price / Prix Código € / 1KG
1 KG = 10 M	20mm	2PB20 5,16
1 KG = 8 M	28mm	2PB28 5,16

ABRAÇADEIRA REFORÇADA M8 / M8+M10

REINFORCED PIPE CLAMP M8 / M8+M10

COLLIER RENFORCÉ M8 / M8+M10

ABRAZADERA REFORZADA M8 / M8+M10

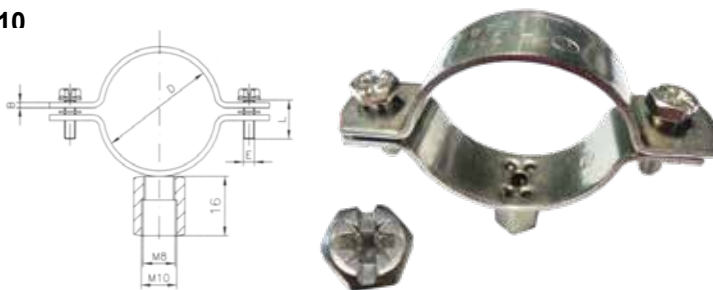

Units/ Box	Size / Maß/Medida /Mesure			Banda	Parafuso	W4			
	"	Ø (mm)	Aperto	Band	Screw	M8		M8+M10	
			Range			Code / Price / Prix		Code / Price / Prix	
			Serrage	Bande	Vis	Código	€/100PCS	Código	€/100PCS
50	3/8	18	16-20	20x2	M6x16	2APRMI018	75,33	2APDRMI018	107,87
50	1/2	22	20-25	20x2	M6x16	2APRMI022	78,65	2APDRMI022	111,03
50	3/4	28	26-31	20x2	M6x16	2APRMI028	83,20	2APDRMI028	115,36
50	1"	35	31-36	20x2	M6x16	2APRMI035	88,63	2APDRMI035	120,54
50	1 1/4	40	38-44	20x2	M6x16	2APRMI040	92,40	2APDRMI040	124,13
50	1 1/2	48	45-51	20x2	M6x20	2APRMI048	100,29	2APDRMI048	131,65
50		54	52-57	20x2	M6x20	2APRMI054	104,92	2APDRMI054	136,05
50	2"	60	57-63	20x2	M6x20	2APRMI060	112,38	2APDRMI060	143,16
50		70	69-73	20x2	M6x20	2APRMI070	123,00	2APDRMI070	151,14
50	2 1/2	75	73-77	20x2	M6x20	2APRMI075	129,15	2APDRMI075	159,13
25		84	83-86	20x2	M6x20	2APRMI084	134,62	2APDRMI084	164,34
25	3"	90	87-94	20x2	M6x20	2APRMI090	140,84	2APDRMI090	170,26
25		104	103-110	20x2	M6x20	2APRMI104	147,47	2APDRMI104	176,58
25	4"	110	107-114	20x2	M6x25	2APRMI110	155,80	2APDRMI110	184,51
25	4"	115	110-118	20x2	M6x25	2APRMI115	159,64	2APDRMI115	188,67
25	5"	125	123-131	20x2	M6x25	2APRMI125	171,30	2APDRMI125	202,41
25		129				2APRMI129	181,86		
25		133	131-135	20x2	M6x25	2APRMI133	187,14	2APDRMI133	210,03
25	5"	140	136-145	20x2	M6x25	2APRMI140	202,97	2APDRMI140	217,64
25		150	147-155	20x2	M6x25	2APRMI154	216,55	2APDRMI154	231,23
25		154	153-159			2APRMI155	223,81		
25	6"	160	158-164	20x2	M6x25	2APRMI160	231,07	2APDRMI160	245,75
25		180	178-184	20x2	M6x25	2APRMI180	247,95	2APDRMI180	262,63
25		204	200-206	28x2	M6x25	2APRMI204	386,89	2APDRMI204	419,77
25		220	216-226	28x2	M6x30	2APRMI220	418,53	2APDRMI220	451,44
25		225	223-227	28x2	M6x30	2APRMI225	427,00	2APDRMI225	459,91
25		250	249-256	28x2	M6x30	2APRMI250	463,02	2APDRMI250	495,93
25		280	279-285	28x2	M6x30	2APRMI280	506,29	2APDRMI280	539,20
25		300	300-307	28x2	M6x30	2APRMI300	546,96	2APDRMI300	579,84
25		315	314-321	28x2	M6x30	2APRMI315	586,67	2APDRMI315	619,56
25		350	350-359	28x2	M6x30	2APRMI350	636,01	2APDRMI350	668,92
25		400	398-408	28x2	M6x30	2APRMI400	654,39	2APDRMI400	687,30
25		500	499-505	28x2	M6x30	2APRMI500	785,81	2APDRMI500	818,69

PARAFUSO PARA ABRAÇADEIRA

SCREW CLAMP

VIS POUR COLLIER

TORNILLO PARA ABRAZADERA

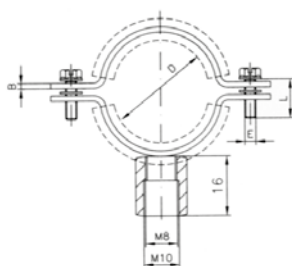

Size / Maß	A2	
Medida / Measure	Code / Price / Prix	
Mesure	Código	€/100PCS
M8x50	2PAI850	22,58

ABRAÇADEIRA REFORÇADA M8 / M8+M10 COM BORRACHA PVC**ISOPHONIC PIPE CLAMP M8 / M8+M10 WITH PVC RUBBER****COLLIER EN CAOUTCHOUC PVC RENFORCÉ M8 / M8+M10****ABRAZADERA REFORZADA M8 / M8+M10 CON GOMA EN PVC**

Borracha Preta ou Amarela / Yellow or Black Rubber/ Caoutchouc Jaune ou Noir / Goma Amarillo o Negro

Units/ Box	Size / Maß/Medida /Mesure			Banda	Parafuso	W4			
	"	Ø (mm)	Aperto Range Serrage	Band Bande	Screw Vis	M8		M8+M10	
						Code / Price / Prix		Code / Price / Prix	
						Código	€/100PCS	Código	€/100PCS
50	3/8	18	17-20	20x2	M6x16	2APRMBI018	114,99	2APDRMBI018	125,32
50	1/2	22	21-26	20x2	M6x16	2APRMBI022	114,99	2APDRMBI022	129,67
50	3/4	28	26-29	20x2	M6x16	2APRMBI028	120,68	2APDRMBI028	135,36
50	1"	35	32-36	20x2	M6x16	2APRMBI035	126,97	2APDRMBI035	141,64
25	1 1/4	40	39-42	20x2	M6x16	2APRMBI040	133,96	2APDRMBI040	148,64
25	1 1/2	48	46-50	20x2	M6x20	2APRMBI048	143,21	2APDRMBI048	157,88
25		54	53-57	20x2	M6x20	2APRMBI054	155,77	2APDRMBI054	170,45
25	2"	60	60-66	20x2	M6x20	2APRMBI060	168,34	2APDRMBI060	183,02
25		70	68-73	20x2	M6x20	2APRMBI070	179,60	2APDRMBI070	196,56
25	2 1/2	75	75-80	20x2	M6x20	2APRMBI075	190,86	2APDRMBI075	205,54
25		84	81-89	20x2	M6x20	2APRMBI084	196,28	2APDRMBI084	210,96
25	3"	90	90-95	20x2	M6x20	2APRMBI090	203,90	2APDRMBI090	218,58
25		100	98-103	20x2	M6x20	2APRMBI100	211,02	2APDRMBI100	225,69
25	4"	110	107-115	20x2	M6x25	2APRMBI110	221,69	2APDRMBI110	236,36
25	4"	115	114-119	20x2	M6x25	2APRMBI115	228,80	2APDRMBI115	243,48
25	5"	125	123-131	20x2	M6x25	2APRMBI125	247,77	2APDRMBI125	262,44
		133	131-138	20x2	M6x25	2APRMBI133	254,29	2APDRMBI133	268,96
25	5"	140	140-149	20x2	M6x25	2APRMBI140	260,81	2APDRMBI140	275,48
25		150	148-155	20x2	M6x25	2APRMBI154	276,45	2APDRMBI154	291,13
25	6"	160	158-166	20x2	M6x25	2APRMBI160	285,46	2APDRMBI160	300,14
25		180	177-184	20x2	M6x25	2APRMBI180	308,11	2APDRMBI180	322,78
25		204	201-210	28x2	M6x25	2APRMBI204	439,76	2APDRMBI204	472,64
25		220	213-225	28x2	M6x30	2APRMBI220	474,67	2APDRMBI220	507,56
25		225	223-228	28x2	M6x30	2APRMBI225	485,09	2APDRMBI225	518,00
25		250	249-255	28x2	M6x30	2APRMBI250	525,03	2APDRMBI250	557,91
25		280	279-285	28x2	M6x30	2APRMBI280	574,17	2APDRMBI280	607,05
25		300	299-304	28x2	M6x30	2APRMBI300	606,71	2APDRMBI300	639,60
25		315	313-325	28x2	M6x30	2APRMBI315	634,85	2APDRMBI315	667,77
25		350	354-359	28x2	M6x30	2APRMBI350	692,04	2APDRMBI350	724,92
25		400	399-406	28x2	M6x30	2APRMBI400	0,00	2APDRMBI400	0,00
25		500	499-506	28x2	M6x30	2APRMBI500	0,00	2APDRMBI500	0,00

ABRAÇADEIRA REFORÇADA M8 / M8+M10

REINFORCED PIPE CLAMP M8 / M8+M10

COLLIER RENFORCÉ M8 / M8+M10

ABRAZADERA REFORZADA M8 / M8+M10



Units/ Box	Size / Maß/Medida /Mesure			Banda	Parafuso	W5			
	"	Ø (mm)	Aperto	Band	Screw	M8		M8+M10	
			Range			Code / Price / Prix	Code / Price / Prix		
			Serrage	Bande	Vis	Código	€/100PCS	Código	€/100PCS
50	3/8	18	16-20	20x2	M6x16	2APRI018	115,76	2APDRI018	148,44
50	1/2	22	20-25	20x2	M6x16	2APRI022	124,09	2APDRI022	153,82
50	3/4	28	26-31	20x2	M6x16	2APRI028	135,36	2APDRI028	161,17
50	1"	35	31-36	20x2	M6x16	2APRI035	143,03	2APDRI035	169,85
50	1 1/4	40	38-44	20x2	M6x16	2APRI040	152,66	2APDRI040	175,91
50	1 1/2	48	45-51	20x2	M6x20	2APRI048	164,58	2APDRI048	187,87
50		54	52-57	20x2	M6x20	2APRI054	176,66	2APDRI054	195,36
50	2"	60	57-63	20x2	M6x20	2APRI060	187,93	2APDRI060	206,35
50		70	69-73	20x2	M6x20	2APRI070	197,15	2APDRI070	219,91
50	2 1/2	75	73-77	20x2	M6x20	2APRI075	206,38	2APDRI075	233,47
25		84	83-86	20x2	M6x20	2APRI084	217,32	2APDRI084	242,31
25	3"	90	87-94	20x2	M6x20	2APRI090	228,10	2APDRI090	251,71
25		100	97-104	20x2	M6x20	2APRI100	249,81	2APDRI100	267,77
25	4"	110	104-114	20x2	M6x25	2APRI110	262,22	2APDRI110	280,18
25	4"	115	110-118	20x2	M6x25	2APRI115	269,24	2APDRI115	287,20
25	5"	125	123-131	20x2	M6x25	2APRI125	280,34	2APDRI125	299,21
25		133	131-135	20x2	M6x25	2APRI133	289,73	2APDRI133	310,34
25	5"	140	136-145	20x2	M6x25	2APRI140	299,12	2APDRI140	321,46
25		150	147-155	20x2	M6x25	2APRI154	328,35	2APDRI154	346,31
25	6"	160	158-164	20x2	M6x25	2APRI160	340,10	2APDRI160	358,71
25		180	178-184	20x2	M6x25	2APRI180	366,06	2APDRI180	384,02
25		204	200-206	28x2	M6x25	2APRI204	538,66	2APDRI204	563,75
25		220	216-226	28x2	M6x30	2APRI220	583,31	2APDRI220	608,41
25		225	223-227	28x2	M6x30	2APRI225	595,20	2APDRI225	620,32
25		250	249-256	28x2	M6x30	2APRI250	646,09	2APDRI250	671,18
25		280	279-285	28x2	M6x30	2APRI280	707,31	2APDRI280	732,43
25		300	300-307	28x2	M6x30	2APRI300	759,10	2APDRI300	770,88
25		315	314-321	28x2	M6x30	2APRI315	809,12	2APDRI315	806,07
25		350	350-359	28x2	M6x30	2APRI350	878,67	2APDRI350	875,62
25		400	398-408	28x2	M6x30	2APRI400	904,33	2APDRI400	1018,75
25		500	499-505	28x2	M6x30	2APRI500	1090,25	2APDRI500	1161,89

ABRAÇADEIRA REFORÇADA M8 / M8+M10 COM BORRACHA PVC

ISOPHONIC PIPE CLAMP M8 / M8+M10

COLLIER EN CAOUTCHOUC RENFORCÉ M8 / M8+M10

ABRAZADERA REFORZADA M8 / M8+M10 CON GOMA



Borracha Preta ou Amarela / Yellow or Black Rubber/ Caoutchouc Jaune ou Noir / Goma Amarillo o Negro

Units/ Box	Size /Medida /Measure			Banda	Parafuso	W5			
	"	Ø (mm)	Aperto	Band	Screw	M8		M8+M10	
			Range			Code / Price / Prix		Code / Price / Prix	
			Serrage			Código	€/100PCS	Código	€/100PCS
50	3/8	18	17-20	20x2	M6x16	2APBI018	160,31	2APDBI018	171,36
50	1/2	22	21-26	20x2	M6x16	2APBI022	163,23	2APDBI022	174,13
50	3/4	28	26-29	20x2	M6x16	2APBI028	172,90	2APDBI028	183,31
50	1"	35	32-36	20x2	M6x16	2APBI035	182,02	2APDBI035	191,98
25	1 1/4	40	39-42	20x2	M6x16	2APBI040	192,41	2APDBI040	201,85
25	1 1/2	48	46-50	20x2	M6x20	2APBI048	208,83	2APDBI048	217,45
25		54	53-57	20x2	M6x20	2APBI054	222,87	2APDBI054	230,79
25	2"	60	60-66	20x2	M6x20	2APBI060	243,12	2APDBI060	250,02
25		70	68-73	20x2	M6x20	2APBI070	252,97	2APDBI070	259,37
25	2 1/2	75	75-80	20x2	M6x20	2APBI075	262,81	2APDBI075	268,73
25		84	81-89	20x2	M6x20	2APBI084	279,23	2APDBI084	284,32
25	3"	90	90-95	20x2	M6x20	2APBI090	293,45	2APDBI090	297,84
25		100	98-103	20x2	M6x20	2APBI100	320,08	2APDBI100	323,14
25	4"	110	107-115	20x2	M6x25	2APBI110	336,31	2APDBI110	338,56
25	4"	115	114-119	20x2	M6x25	2APBI115	342,15	2APDBI115	344,10
25	5"	125	123-131	20x2	M6x25	2APBI125	355,28	2APDBI125	356,58
25		133	131-138	20x2	M6x25	2APBI133	368,69	2APDBI133	369,48
25	5"	140	140-149	20x2	M6x25	2APBI140	382,10	2APDBI140	382,04
25		150	148-155	20x2	M6x25	2APBI154	419,31	2APDBI154	417,39
25	6"	160	158-164	20x2	M6x25	2APBI160	435,35	2APDBI160	432,64
25		180	177-184	20x2	M6x25	2APBI180	470,01	2APDBI180	465,56
25		204	201-210	28x2	M6x25	2APBI204	589,67	2APDBI204	616,62
25		220	213-225	28x2	M6x30	2APBI220	637,59	2APDBI220	664,55
25		225	223-227	28x2	M6x30	2APBI225	651,42	2APDBI225	678,41
25		250	249-255	28x2	M6x30	2APBI250	706,21	2APDBI250	733,19
25		280	279-285	28x2	M6x30	2APBI280	773,33	2APDBI280	800,29
25		300	300-307	28x2	M6x30	2APBI300	816,97	2APDBI300	843,95
25		315	313-325	28x2	M6x30	2APBI315	855,44	2APDBI315	882,42
25		350	350-359	28x2	M6x30	2APBI350	932,83	2APDBI350	959,79
25		400	398-408	28x2	M6x30	2APBI400	0,00	2APDBI400	
25		500	499-505	28x2	M6x30	2APBI500	0,00	2APDBI500	

BASE RECTÂNGULAR COM PORCA M8+M10

RECTANGULAR BASE WITH NUT M8+M10

Und Cx	Size / Maß Medida / Mesure	W5	
		Code Código	Price / Prix €/100PCS
	M8+M10	2BRI	92,40



ABRAÇADEIRA DE PÊRA

PEAR CLAMP

COLLIER POIRE

ABRAZADERA PERA



Preços Sem Rebite / Prices without Rivet

Prix sans Rivet / Los precios no incluyen Rivet

Borracha EPDM Preta ou Amarela / Yellow or Black EPDM Rubber/ Caoutchouc EPDM Jaune ou Noir / Goma EPDM Amarillo o Negro

Units/ Box	Ø (mm)	W1				W4			
		Simples		Com Borracha		Simples		Com Borracha	
		Simple Code / Price / Prix Código €/100PCS		With Rubber Code / Price / Prix Código €/100PCS		Simple Code / Price / Prix Código €/100PCS		With Rubber Code / Price / Prix Código €/100PCS	
50	28	1APS25	13,63	1API28	22,20	1APSI25	31,35	1APII28	42,83
50	35	1APS35	15,43	1API35	25,01	1APSI35	37,31	1APII35	50,33
50	42	1APS40	17,54	1API40	28,23	1APSI40	44,44	1APII40	59,13
50	48	1APS48	18,06	1API48	30,21	1APSI48	45,90	1APII48	62,27
50	60	1APS60	21,61	1API60	36,73	1APSI60	55,42	1APII60	75,67
50	75	1APS75	24,58	1API75	42,37	1APSI75	65,54	1APII75	89,38
25	90	1APS90	28,38	1API90	50,15	1APSI90	75,88	1APII90	104,74
25	100	1APS100	30,34		0,00	1APSI100	82,61		
25	110	1APS110	32,30	1API110	54,65	1APSI110	89,33	1APII110	119,86
25	115	1APS115	34,01	1API115	57,37	1APSI115	94,03	1APII115	125,97
25	125	1APS125	42,73		0,00	1APSI125	109,69		
25	140	1APS140	51,46	1API140	78,56	1APSI140	125,34	1APII140	163,63
25	165	1APS160	58,54	1API165	89,33	1APSI160	145,36	1APII160	189,05
10	180	1APS170	64,12	1API180	97,39	1APSI170	158,38	1APII170	205,68
10	200	1APS200	69,25	1API200	105,55	1APSI200	172,78	1APII200	224,40
10	220	1APS220	74,22	1API220	113,80	1APSI220	186,79	1APII220	242,98
10	250	1APS250	79,79						
10	275	1APS275	85,25						

PORCA REBITAR ESTRIADA

RIVET STRIATED NUT

ÉCROU RIVETAGE STRIÉS

TUERCA REMACHAR ESTRIADO



Size / Maß	W1		W4	
Medida / Mesure	Code / Price / Prix Código	€/100PCS	Code / Price / Prix Código	€/100PCS
8	2PR08	7,63	2PRI08	46,97
10	2PR10	12,34	2PRI100	65,43

CAPAS

BRIDGE CLAMP

COLLIER PONT



1 Peça / Piece / Pièce

Und Cx	Ø (mm)	Banda Band Bande	Acabamento Finishing Finition	W4	
				Code / Price / Prix	
				Código	€/100PCS
50	Ø 12	20x2	Polido	2TAPA12	17,69
50	Ø 18	20x2	Polido	2TAPA18	19,69
50	Ø 22	20x2	Polido	2TAPA22	21,39
50	Ø 28	20x2	Polido	2TAPA28	23,54
50	Ø 34	20x2	Polido	2TAPA34	26,05
50	Ø 40	20x2	Polido	2TAPA40	27,92
50	Ø 53	20x3	Polido	2TAPA53	47,91
50	Ø 60,3	20x3	Polido	2TAPA60,3	52,69
50	Ø 63	20x3	Polido	2TAPA63	53,76
50	Ø 70	20x3	Polido	2TAPA70	56,18
50	Ø 76	20x3	Polido	2TAPA76	66,67
50	Ø 85	25x3	Polido	2TAPA85	85,69
50	Ø 88,9	25x3	Polido	2TAPA88.9	89,25
50	Ø 104	25x3	Polido	2TAPA104	94,75
50	Ø 114,3	30x4	Polido	2TAPA114,3	179,78
50	Ø 129	30x4	Polido	2TAPA129	193,04
50	Ø 154	40x4	Polido	2TAPA154	300,48
50	Ø 168	40x4	Polido	2TAPA168	326,33
50	Ø 204	40x4	Polido	2TAPA204	392,81
50	Ø 254	40x4	Polido	2TAPA254	464,10
50	Ø 320	40x4	Polido	2TAPA320	574,84
50	Ø 356	40x4	Polido	2TAPA356	631,31
50	Ø 406	40x4	Polido	2TAPA406	715,92
50	Ø 457	40x4	Polido	2TAPA457	792,94
50	Ø 508	40x4	Polido	2TAPA508	869,94
50	Ø 609	40x4	Polido	2TAPA609	1029,68

ABRAÇADEIRA ALIMENTÁRIA DIN 3567

HOOD CLAMP DIN 3567

COLLIER CAPOT DIN 3567

ABRAZADERA ALIMENTARIA DIN 3567



1 Conjunto / 1 Set

Und Cx	Ø (mm)	Banda Band Bande	Parafuso DIN 933 Porca DIN 985	Acabamento Finishing Finition	W4	
					Code / Price / Prix	
					Código	€/100PCS
100	Ø 12	20x2	M6x20 / M6	Polido	2CAPA12	59,44
100	Ø 18	20x2	M6x20 / M6	Polido	2CAPA18	63,44
50	Ø 22	20x2	M6x20 / M6	Polido	2CAPA22	66,84
50	Ø 28	20x2	M6x20 / M6	Polido	2CAPA28	71,14
50	Ø 34	20x2	M6x20 / M6	Polido	2CAPA34	76,17
50	Ø 40	20x2	M6x20 / M6	Polido	2CAPA40	79,89
25	Ø 52	20x3	M8x30 / M8	Polido	2CAPA52	135,59
	Ø 60,3	20x3	M8x30 / M8	Polido	2CAPA60	139,78
25	Ø 63	20x3	M8x30 / M8	Polido	2CAPA63	147,29
25	Ø 70	20x3	M8x30 / M8	Polido	2CAPA70	152,13
25	Ø 76	20x3	M8x30 / M8	Polido	2CAPA76	172,04
20	Ø 85	25x3	M8x30 / M8	Polido	2CAPA85	206,80
	Ø 88,9	25x3	M8x40 / M8	Polido	2CAPA88	225,81
15	Ø 104	25x3	M8x40 / M8	Polido	2CAPA104	238,09
	Ø 114,3	30x4	M8x40 / M8	Polido	2CAPA114	424,52
8	Ø 129	30x4	M8x40 / M8	Polido	2CAPA129	426,48
5	Ø 154	40x4	M8x40 / M8	Polido	2CAPA154	646,15
5	Ø 168	40x4	M8x40 / M8	Polido	2CAPA168	698,28
5	Ø 204	40x4	M8x40 / M8	Polido	2CAPA204	832,35
5	Ø 254	40x4	M8x40 / M8	Polido	2CAPA254	976,12
5	Ø 320	40x4	M8x40 / M8	Polido	2CAPA320	1201,08
5	Ø 356	40x4	M8x40 / M8	Polido	2CAPA356	1315,05
5	Ø 406	40x4	M8x40 / M8	Polido	2CAPA406	1486,02
5	Ø 457	40x4	M8x40 / M8	Polido	2CAPA457	1641,94
5	Ø 508	40x4	M8x40 / M8	Polido	2CAPA508	1797,85

GRAPA SIMPLES

CONDUIT CLIP

GRAPAS PUENTE

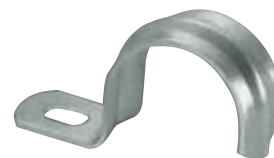

Units/Box	Size / Maß/Medida /Measure		Banda Band Bande	W1		W4	
	"	Ø (mm)		Code / Price / Prix Código € / 100PCS		Code / Price / Prix Código € / 100PCS	
100		8	15x1,2	1GS08	1,82		
100	1/8	10	15x1,2	1GS10	1,90		
100	1/4	12	15x1,2	1GS12	2,25	1GSI12	9,15
100		14	15x1,2	1GS14	2,71		
100		15	15x1,2	1GS15	3,32	1GSI15	10,22
100	3/8	16	15x1,2	1GS16	3,57	1GSI16	10,43
100		18	15x1,2	1GS18	4,02	1GSI18	11,62
100	1/2	20	15x1,2	1GS20	4,45	1GSI20	12,59
100		22	15x1,2	1GS22	5,06	1GSI22	13,63
100		25	15x1,2	1GS25	5,62	1GSI25	14,18
100	3/4	26	15x1,2	1GS26	6,32		
100		28	15x1,2	1GS28	6,41	1GSI28	15,65
100	1"	32	15x1,2	1GS32	7,11	1GSI32	17,07
100		35	15x1,2	1GS35	7,97	1GSI35	18,80
50		40	15x1,2	1GS40	14,97		
50	1 1/4	42	15x1,2	1GS42	15,35	1GSI42	21,17
50	1 1/2	47	16x1,5	1GS47	16,37		
50		50	16x1,5	1GS050	16,94		

GRAPA EM U

BRIDGE CONDUIT CLIP

GRAPAS PUENTE



Units/Box	Size / Maß/Medida /Measure		Banda Band Bande	W1		W4	
	"	Ø (mm)		Code / Price / Prix Código € / 100PCS		Code / Price / Prix Código € / 100PCS	
100		8	15x1	1GU08	3,72		
100	1/8	10	15x1	1GU10	3,91		
100	1/4	12	15x1	1GU12	4,08		
100		14	15x1	1GU14	4,41		
100		15	15x1	1GU15	4,83	1GUI15	16,79
100	3/8	16	15x1	1GU16	4,83		
100		18	15x1	1GU18	5,26	1GUI18	18,90
100	1/2	20	15x1	1GU20	6,01		
100		22	15x1,2	1GU22	6,57	1GUI22	21,27
100		25	15x1,2	1GU24	7,86	1GUI25	22,65
100	3/4	26	15x1,2	1GU26	8,31	1GUI26	22,65
100		28	15x1,2	1GU28	8,74	1GUI28	22,64
50	1"	32	16x1,5	1GU32	9,75		
50		40	16x1,5	1GU40	14,36		
50	1 1/4	42	16x1,5	1GU42	15,04	1GUI42	31,58
50	1 1/2	47	16x1,5	1GU47	16,80		
50		50	16x1,5	1GU50	16,94		
50	2"	63	16x1,5	1GU63	19,49		
50	2 1/2	75	16x1,5	1GU75	19,87		
50	3"	90	16x1,5	1GU90	21,70		

GRAPA DUPLA

DOUBLE CONDUIT CLIP

GRAPA DOBLE



Units/Box	Size / Maß/Medida /Measure		Banda Band Bande	W1		W4	
	"	Ø (mm)		Code / Price / Prix Código € / 100PCS		Code / Price / Prix Código € / 100PCS	
100	3/8	15	15x1,2	1GD15	4,63	1GDI15	15,29
100		16	15x1,2	1GD16	4,92	1GDI16	15,67
100		18	15x1,2	1GD18	5,31	1GDI18	16,43
100	1/2	20	15x1,2	1GD20	6,03	1GDI20	18,83
100		22	15x1,2	1GD22	6,30	1GDI22	19,23
100	3/4	25	15x1,2	1GD25	7,02	1GDI25	21,62
100		28	15x1,2	1GD28	7,45	1GDI28	22,76
100	1"	32	15x1,2	1GD32	8,60	1GDI32	27,05
100		35	15x1,2	1GD35	9,01	1GDI35	28,07
100		42	15x1,2	1GD42	9,96	1GDI42	31,75

PARAFUSO PARA CALHA PERFURADA

PERFORATED GUTTER SCREW

VIS POUR GOUTTIERE PERFORÉ

TORNILLO PARA GUÍA



Units/Box	Size / Maß Medida / Measure	Aplicação em Calha Gutter Application Application en Gouttière	W1	
			Code	Price / Prix
			Código	€/100PCS
100	M8x20	27/18 E 28/30	2PP20	22,15
100	M8x30	27/18 E 28/30	2PP30	24,39
100	M8x30	38/40	2PP330	33,76
100	M10x30	38/40	2PP3130	37,60
100	M8x40	41/21 E 41/41	2PP440	35,56
100	M10x40	41/21 E 41/41	2PP4140	37,60

PORCA PARA CALHA PERFURADA

PERFORATED GUTTER NUT

ÉCROU POUR GOUTTIERE PERFORÉ

TUERCAS PARA GUÍA



Units/Box	Size / Maß Medida / Measure	Aplicação em Calha Gutter Application Application en Gouttière	W1	
			Code	Price / Prix
			Código	€/100PCS
100	M6	20/10	2PPC620	7,34
100	M8	20/10	2PPC820	7,34
100	M8	27/18	2PPC827	7,11
100	M10	27/18	2PPC1027	7,11
100	M12	27/18	2PPC12	19,76
100	M8	38/40	2PPC840	15,24
100	M10	38/40	2PPC1040	15,24



Units/Box	Size / Maß Medida / Measure	Aplicação em Calha Gutter Application Application en Gouttière	W1	
			Code	Price / Prix
			Código	€/100PCS
100	M8	41/21 E 41/41	2PPC841	15,24
100	M10	41/21 E 41/41	2PPC1041	17,27
100	M12	41/21 E 41/41	2PPC1241	18,29

SOPORTES PERFORADOS



SOPORTE HORIZONTAL



ABARCONES COMPLETOS DIN 3570

U BOLT DIN 3570

ÉTRIER COMPLET DIN 3570

ABARCÓN COMPLETO (TUERCA Y ARANDELA) DIN 3570

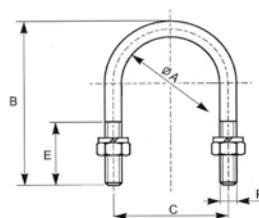

Aço 8.8 Sob Consulta/Steel 8.8 Under Request/Acier 8.8 Sur Demande/Acero 8.8 A petición

Tratamentos Dacromet e Geomet sob consulta/Dacromet and Geomet Treatment Under Request

Traitement Dacromet et Geomet sur Demande/Tratamiento Dacromet Y Geomet a petición

Aço Zincado 4.6 / Galvanized Steel 4.6 / Acier Zingué 4.6

Units/ Box	Size / Maß/Medida / Mesure							W1	
	"	Ø mm (A)	(mm) (B)	(mm) (C)	(mm) (E)	(R)	Comp. Aço	Code Código	Price / Prix €/100PCS
100	3/8	18	50	24	35	M6	114	2AB38	16,50
100	1/2	22	53	28	35	M6	122	2AB12	16,86
100	3/4	28	59	34	35	M6	137	2AB34	17,45
100	1"	34	65	40	35	M6	153	2AB1	18,11
100	Ø 38	39	70	42	35	M6	166	2AB038	18,64
100	1 1/4	43	74	49	35	M6	176	2AB114	19,06
100	1 1/2	49	85	57	40	M8	203	2AB112	29,87
100	Ø 53	54	96	61	40	M8	227	2AB053	31,51
100	Ø 54	55	97	62	40	M8	230	2AB054	31,87
100	2"	61	99	70	40	M8	237	2AB2	32,39
100	Ø 65	66	98	73	40	M8	238	2AB065	32,51
100	Ø 70	71	102	78	40	M8	249	2AB070	33,41
100	2 1/2	77	113	83	40	M8	275	2AB212	35,19
50	Ø 84	85	117	94	40	M8	287	2AB084	36,02
50	3"	90	126	98	40	M8	308	2AB3	37,60
50	Ø104	105	149	114	40	M10	364	2AB104	73,05
50	4"	115	155	125	40	M10	381	2AB4	75,85
50	Ø129	130	170	140	40	M10	420	2AB129	81,04
50	5"	144	184	154	40	M10	456	2AB5	85,92
25	Ø154	155	194	164	40	M10	482	2AB154	89,72
25	6"	170	210	180	40	M10	523	2AB6	95,27
25	Ø204	206	244	214	40	M10	611	2AB204	106,01
25	8"	221	259	230	40	M10	650	2AB8	111,36
25	Ø254	256	294	264	40	M10	740	2AB254	122,32
25	10"	275	313	284	40	M10	789	2AB10	128,79
25	Ø304	306	344	314	50	M10	868	2AB304	138,54
25	12"	324	368	334	50	M10	916	2AB012	147,21
25	Ø350	354	407	364	50	M10	1016	2AB350	155,89

ABARCONES PARA VIGOTAS (KIWIS)

U BOLT FOR SMALL BEAM

ÉTRIER POUR GOUTTIERE

ABARCÓN PARA VIGA



Size / Maß Medida / Measure	W1	
	Code Código	Price / Prix €/100PCS
M10x360	2GK360	104,88
M10x380	2GK380	108,35
M10x400	2GK400	111,00
M10x420	2GK420	113,65
M10x440	2GK440	116,29
M10x460	2GK460	118,94
M10x480	2GK480	121,58
M10x500	2GK500	124,23

ABARCONES COMPLETOS DIN 3570

U BOLT DIN 3570

ÉTRIER COMPLET DIN 3570

ABARCÓN COMPLETO (TUERCA Y ARANDELA) DIN 3570

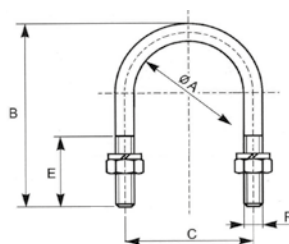

Units/ Box	Size / Maß/Medida / Mesure							W4		W5	
	"	Ø mm (A)	(mm) (B)	(mm) (C)	(mm) (E)	(R)	Comp. Aço	Code	Price /Prix	Code	Price /Prix
								Código	€/100PCS	Código	€/100PCS
100	3/8	18	50	24	35	M6	114	2ABI38	33,74	2ABI538	46,28
100	1/2	22	53	28	35	M6	122	2ABI12	35,00	2ABI512	48,02
100	3/4	28	59	34	35	M6	137	2ABI34	37,20	2ABI534	51,06
100	1"	34	65	40	35	M6	153	2ABI1	39,67	2ABI51	54,47
100	Ø 38	39	70	42	35	M6	166	2ABI038	41,61	2ABI5038	57,16
100	1 1/4	43	74	49	35	M6	176	2ABI114	43,13	2ABI5114	59,25
100	1 1/2	49	85	57	40	M8	203	2ABI112	80,04	2ABI5112	111,33
100	Ø 53	54	96	61	40	M8	227	2ABI053	86,14	2ABI5053	119,75
100	Ø 54	55	97	62	40	M8	230	2ABI054	87,28	2ABI5054	121,29
100	2"	61	99	70	40	M8	237	2ABI2	89,12	2ABI52	123,85
100	Ø 65	66	98	73	40	M8	238	2ABI065	89,43	2ABI5065	124,28
100	Ø 70	71	102	78	40	M8	249	2ABI070	92,47	2ABI5070	128,41
100	2 1/2	77	113	83	40	M8	275	2ABI212	99,34	2ABI5212	137,94
50	Ø 84	85	117	94	40	M8	287	2ABI084	102,50	2ABI5084	142,33
50	3"	90	126	98	40	M8	308	2ABI3	108,19	2ABI53	150,19
50	Ø104	105	149	114	40	M10	364	2ABI104	211,92	2ABI5104	293,76
50	4"	115	155	125	40	M10	381	2ABI4	220,17	2ABI54	304,94
50	Ø129	130	170	140	40	M10	420	2ABI129	237,86	2ABI5129	329,19
50	5"	144	184	154	40	M10	456	2ABI5	254,33	2ABI55	351,77
25	Ø154	155	194	164	40	M10	482	2ABI154	266,47	2ABI5154	368,35
25	6"	170	210	180	40	M10	523	2ABI6	285,13	2ABI56	393,97
25	Ø204	206	244	214	40	M10	611	2ABI204	324,16	2ABI5204	447,81
25	8"	221	259	230	40	M10	650	2ABI8	342,06	2ABI58	472,34
25	Ø254	256	294	264	40	M10	740	2ABI254	381,94	2ABI5254	527,38
25	10"	275	313	284	40	M10	789	2ABI10	404,16	2ABI510	557,93
25	Ø304	306	344	314	50	M10	868	2ABI304	439,27	2ABI5304	606,37
25	12"	324	368	334	50	M10	916	2ABI012	471,72	2ABI5012	651,27
25	Ø350	354	407	364	50	M10	1016	2ABI350	504,16	2ABI5350	696,17

Preços Sob Consulta / Prices under request / Prix sur demande / Precios á petición



ABRAÇADEIRA DE FIVELA EM POLIAMIDA 6.6

POLYAMIDE 6.6 CABLE TIES

COLLIER DE SERRAGE EN POLYAMIDE 6.6

BRIDAS NYLON POLIAMIDA 6,6



Und		Medida Size Mesure	Resistência (KG) Resistance (KG) Resistencia (KG)	Branco / White / Blanc		Preto / Black / Noir	
Saco	Caixote			Code Código	Price /Prix €/100PCS	Code Código	Price /Prix €/100PCS
100	15000	2,5x98	8,16	1AFB2598	0,45	1AFP2598	0,45
100	12000	2,5x135	8,16	1AFB25135	0,72	1AFP25135	0,72
100	10000	2,5x160	8,16	1AFB26160	0,83	1AFP26160	0,83
100	8000	2,5x200	8,16	1AFB26200	0,98	1AFP26200	0,98
100	7000	3,5x140	13,26	1AFB36140	0,91	1AFP36140	0,91
100	7000	3,5x200	13,26	1AFB36200	1,48	1AFP36200	1,48
100	4500	3,5x290	13,26	1AFB36290	1,96	1AFP36290	1,96
100	5000	4,5x178	22,44	1AFB48178	1,60	1AFP48178	1,60
100	4000	4,5x200	22,44	1AFB48200	1,73	1AFP48200	1,73
100	4500	4,5x250	22,44	1AFB48250	2,23	1AFP48250	2,23
100	3500	4,5x290	22,44	1AFB48290	2,63	1AFP48290	2,63
100	3000	4,5x360	22,44	1AFB48360	3,31	1AFP48360	3,31
100	5000	4,5x430	22,44	1AFB48430	4,66	1AFP48430	4,66
100	2000	7,5x240	55,08	1AFB78240	5,00	1AFP78240	5,00
100	1500	7,5x300	55,08	1AFB78300	5,84	1AFP78300	5,84
100	1500	7,5x365	55,08	1AFB78365	6,55	1AFP78365	6,55
100	2500	7,5x450	55,08	1AFB78450	9,42	1AFP78450	9,42
100	2000	7,5x540	55,08	1AFB78540	11,21	1AFP78540	11,21
100	1200	7,5x750	55,08	1AFB78750	16,16	1AFP78750	16,16
50	2000	12,5x225	110,00	1AFB126225	15,91	1AFP126225	15,91
50	1000	12,5x500	110,00	1AFB126500	22,75	1AFP126500	22,75
50	600	12,5x720	110,00	1AFB126720	29,67	1AFP126720	29,67
50	500	12,5x1000	110,00	1AFB1261000	48,22	1AFP1261000	48,22

Medida Size Mesure	Amarelo / Yellow		Azul / Blue		Verde / Green / Vert		Vermelho / Red / Rouge	
	Code Código	Price / Prix €/100PCS	Code Código	Price / Prix €/100PCS	Code Código	Price / Prix €/100PCS	Code Código	Price / Prix €/100PCS
2,5X98	1AFAM2598	0,80	1AFA2598	0,80	1AFV2598	0,85	1AFVE2598	0,85
3,5X140	1AFAM36140	1,48	1AFA36140	1,48	1AFV36140	1,56	1AFVE36140	1,56
3,5X200	1AFAM36200	2,02	1AFA36200	2,02	1AFV36200	2,12	1AFVE36200	2,12
4,5X200	1AFAM48200	2,66	1AFA48200	2,66	1AFV48200	2,79	1AFVE48200	2,79
4,5X290	1AFAM48290	3,95	1AFA48290	3,95	1AFV48290	4,15	1AFVE48290	4,15

BUCHA E BASE PARA FIXAR ABRAÇADEIRAS

FIXING CLAMP ANCHOR AND BASIS

CHEVILLE ET BASES POUR COLLIERS DE FIXATION

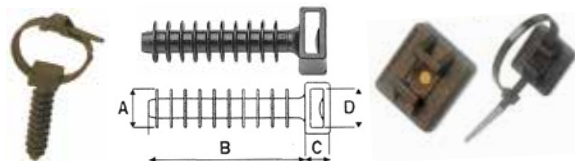

Und Cx	Dimensões Dimensions / Dimensiones		Bucha		Base	
	A x B x D	Furo	Code Código	Price /Prix €/100PCS	Code Código	Price /Prix €/100PCS
100	10x37x9	8	1BFA	2,22	1BA	5,50
100	20x20x3,6					

HASTES ROSCADAS COM 2 ROSCAS DE MADEIRA E MÉTRICA

THREADED RODS WITH 2 WOOD AND METRIC THREAD

TIGES FILETÉES AVEC 2 TIGES BOIS ET METRIQUE

TORNILLO DOBLE ROSCA



Und Cx	Medida Size Mesure	Rosca Threaded Filetage	W1		A2	
			Code / Price / Prix		Code / Price / Prix	
			Código	€/100PCS	Código	€/100PCS
250	M4X20	Ligada	2HR2R420	2,68		
250	M4X30	Ligada	2HR2R430	2,89		
250	M4X40	Ligada	2HR2R440	3,38		
250	M6X40	Ligada	2HR2R640	2,89		
250	M6X45	Ligada	2HR2R645	3,38		
250	M6X50	Ligada	2HR2R650	3,38		
250	M6X60	Ligada	2HR2R660	3,86	2PPAI670	22,04
200	M6X70	Separada	2HR2R670	4,35		
200	M6X80	Separada	2HR2R680	4,84	2PPAI680	22,58
200	M6X90	Separada	2HR2R690	6,24	2PPAI690	26,88
200	M6X100	Separada	2HR2R6100	6,99	2PPAI6100	30,11
200	M6X120	Separada	2HR2R6120	7,42	2PPAI6120	32,26

HASTES ROSCADAS COM 2 ROSCAS DE MADEIRA E MÉTRICA E HEXAGONAL

THREADED RODS WITH 2 WOOD AND METRIC THREAD AND HEXAGONAL

TIGES FILETÉES AVEC 2 TIGES BOIS ET METRIQUE ET HEXAGONAL

ESPÁRRAGO DOBLE ROSCA CON HEXAGONAL



Und Cx	Medida Size Mesure	Rosca Threaded Filetage	W1		A2	
			Code / Price / Prix		Code / Price / Prix	
			Código	€/100PCS	Código	€/100PCS
100	M8X40	Hexagonal ao meio	2PDR840	4,05		
100	M8X50	Hexagonal ao meio	2PDR850	4,41	2PPAI850	24,82
100	M8X60	Hexagonal ao meio	2PDR860	4,73	2PPAI860	25,81
100	M8X70	Hexagonal ao meio	2PDR870	5,59		
100	M8X80	Hexagonal ao meio	2PDR880	6,45	2PPAI880	32,92
100	M8X90	Hexagonal ao meio	2PDR890	7,20		
100	M8X100	Hexagonal ao meio	2PDR8100	7,74	2PPAI8100	40,86
100	M8X110	Hexagonal ao meio	2PDR8110	9,73	2PPAI8110	45,73
100	M8X120	Hexagonal ao meio	2PDR8120	8,82		
100	M8X130	Hexagonal ao meio	2PDR8130	9,46		
100	M8X140	Hexagonal ao meio	2PDR8140	11,83		
100	M10X60	Hexagonal ao meio			2PPAI1060	44,09
100	M10X80	Hexagonal ao meio	2PDR10080	10,34		
100	M10X100	Hexagonal ao meio	2PDR10100	12,80	2PPAI10100	66,67
100	M10X120	Hexagonal ao meio	2PDR10120	14,04		
100	M12X100	Hexagonal ao meio	2PDR12100	20,75		
100	M12X140	Hexagonal ao meio	2PDR12140	31,51		
100	M12X180	Hexagonal ao meio	2PDR12180	38,87		
100	M12X250	Hexagonal ao meio	2PDR12250	56,56		

HASTES ROSCADAS COM 2 ROSCAS DE MADEIRA

THREADED RODS WITH 2 WOOD THREAD

TIGES FILETÉES AVEC 2 TIGES EN BOIS

TORNILLO DOBLE ROSCA DE MADERA



Und Cx	Medida Size Mesure	Rosca Threaded Filetage	W1		A2	
			Code / Price / Prix		Code / Price / Prix	
			Código	€/100PCS	Código	€/100PCS
250	M6,6X70	Separada	2PDRM	6,09		

TERMS AND CONDITIONS

Prices: MSRPs (Manufacturer's Suggested Retail Prices).

Delivery time: Standard products are available in stock (subject to prior sale).

Complaints: Any complaint regarding the quality or technical features of a product needs to be accompanied with the corresponding product label. We cannot accept any complaints without this data.

Return of material: We cannot accept any return of material without prior notice to our Sales Department. A return is only possible within 15 days of the delivery of the material. Lifial reserves the right to charge up to 20% of the total amount for repackaging and handling costs. The customer assumes the cost and risk of the return if the return is not due to a mistake made by Lifial. The corresponding amount of the returned material will be deducted from the next invoice.

IT IS NOT POSSIBLE TO RETURN SPECIAL PRODUCTS.

Payment terms: Invoices must be paid by bank transfer. Our bank details can be found on the order confirmation/invoice.

Please find the complete General Terms and Conditions of NORMA Group Holding GmbH using the following link

or QR code:

http://normagroup.com/norma.nsf/id/Downloads-Terms-Conditions_EN



[illegible]

This image shows a single sheet of white paper with horizontal ruling lines. The lines are evenly spaced and run across the width of the page. There are no margins, text, or other markings on the paper.

This image shows a single sheet of white paper with horizontal ruling lines. The lines are evenly spaced and run across the width of the page. There are no margins, text, or other markings on the paper.



Rua da Ectri, nº 492 | Vale do Grou
Apto. 222
3754-909 Águeda
Portugal

Tel: +351 234 600 040
Fax: +351 234 600 041
info.lifial@normagroup.com
www.lifial.pt
GPS. N 40°32'28" | O 8°27'2"